

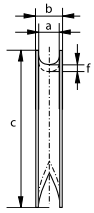

E-6110

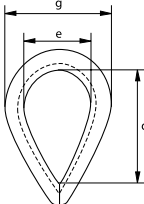

Thimbles

Standard commercial

- **Material:** mild steel
- **Finish:** electro-galvanized
- **Certification:** 2.1 CE IIB

diameter rope	width groove	width overall	length	length inside	width inside	thickness back	width	weight per 100 pcs
mm	a mm	b mm	c mm	d mm	e mm	f mm	g mm	kg
4	4	7	25	16	11	2.5	19	0.50
5	5	8	31	22	16	3	25	0.80
6	6	10	37	26	19	3.5	30	1.40
8	8	12	51	34	24	5	38	2.80
9	9	13	57	38	29	5.5	44	3
10	10	16	64	42	32	5.5	49	4.80
12	12	18	76	51	38	6.5	57	8
14	14	20	82	57	40	8	62	10
16	16	22	89	60	42	9	66	15
18	18	26	102	67	45	10	73	22
20	20	28	115	76	51	11	81	25
22	22	30	127	83	54	12.5	87	32
24	24	32	138	90	64	14	100	46
26	26	36	152	102	68	14.5	107	66
28	28	38	165	110	73	16	115	77
30	30	42	178	120	79	17	125	80
32	32	44	203	143	93	18	141	130

3.1



G-6120

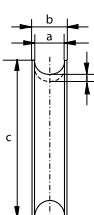
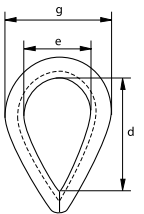

Thimbles

Heavy duty stub-end

- **Material:** mild steel
- **Finish:** hot dipped galvanized
- **Certification:** 2.1 CE IIB

diameter rope	width groove	width overall	length	length inside	width inside	thickness back	width	weight per 100 pcs
mm	a mm	b mm	c mm	d mm	e mm	f mm	g mm	kg
8	9	13	51	35	22	4	44	0.50
10	11	15	64	47	30	4	54	0.80
12	13	18	76	57	35	5	62	1.40
14	15	21	89	65	45	6	76	2.80
16	18	22	102	75	50	6	83	3
18	20	28	114	85	53	7	91	4.80
20	22	30	127	94	60	8	102	8
22	24	31	140	107	65	9	110	10
24	26	34	152	114	70	9.5	118	15
28	30	39	178	130	80	10	134	22
32	34	41	203	157	100	10	162	25
36	38	48	229	175	115	11	182	32
40	42	51	254	198	120	12	188	46
44	46	62	280	214	130	14	210	66
50	53	65	305	220	140	18	248	77
56	57	68	356	245	150	23	262	80
64	67	85	407	286	185	20	280	130

C

Thimbles

Heavy duty stub-end reinforced with welded fillet plate



G-6128

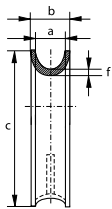
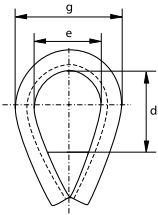

- **Material:** mild steel
- **Finish:** hot dipped galvanized reinforced with a welded fillet plate
- **Certification:** 2.1 CE IIB

width groove	width overall	length	length inside	width inside	thickness back	width	weight per piece
a mm	b mm	c mm	d mm	e mm	f mm	g mm	kg
35	55	220	100	80	10	150	3.20
40	65	245	120	90	12	160	5.10
50	80	290	125	110	16	200	9.20
62	100	360	160	140	20	250	17.4
72	115	390	175	160	20	265	19.4
85	125	470	245	190	20	300	29
100	150	540	290	200	25	370	39
115	165	570	300	210	25	380	52

For shackle

group	width groove								
	a mm								
	35	40	50	62	72	85	100	115	
G-4161	17, 25	25	35, 42.5	55	85				
G-4163	17, 25	25	35, 42.5	55	85				
G-4151	17, 25	25	35, 42.5	55	85				
G-4153	17, 25	25	35, 42.5	55	85				
P-6036						120, 150	150, 200		
G-6038						120, 150	150, 200		
P-6033	30	30	40, 55	75	125	125			
G-5263	30, 40	40		85	120	150, 175	175		
G-5163	17, 25	25	35, 42.5	55	85				
P-6031						120, 150	150, 200		
G-4263	4.75 ~ 25	6.5 ~ 25	9.5 ~ 30	16 ~ 55	25 ~ 75	30 ~ 75	55, 75	75	
P-5363	17, 25	25	35, 42.5	55	85				
P-5365	17, 25	25	35, 42.5	55	85	120, 150	150, 200		
P-5367	17, 25	25	35, 42.5	55	85	120, 150	150		
G-4164	17, 25	25							
G-4154	17, 25	25							
G-4169	17								
G-4159	17								



E-6131
G-6131

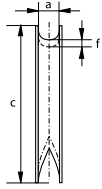
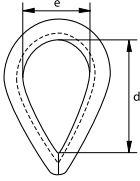

Thimbles

Generally to DIN 6899 (B)

- **Material:** mild steel
- **Standard:** generally to DIN 6899 (B)
- **Finish:** thimbles for rope diameters up to and including 6 mm are electro-galvanized, other diameters are hot dipped galvanized
- **Certification:** 2.1 CE IIB

diameter rope	width groove	length	length inside	width inside	thickness back	weight per 100 pcs
mm	a mm	c mm	d mm	e mm	f mm	kg
2.5	3	22	19	12	1.6	0.60
3.5	4	26	21	13	1.6	0.80
4	5	32	23	14	1.9	1
5	6	38	25	16	2.4	2
6	7	44	28	18	2.4	2
7	8	51	32	20	2.8	2.70
9	10	57	38	24	3.1	4.10
11	12	64	45	28	3.3	6.90
13	13	70	48	30	3.3	7.20
13	14	76	51	32	3.7	10.2
15	16	83	58	36	3.8	16.4
16	17	89	61	38	4.7	19
17	18	95	64	40	4.7	20.3
18	20	102	72	45	5.7	27.3
20	22	114	80	50	5.7	30.8
22	24	127	90	56	6.5	44.8
24	26	140	99	62	6.8	59.2
26	28	152	112	70	8	72
28	30	165	120	75	8	104
30	32	178	128	80	8	115
32	34	203	152	95	8.5	153
34	36	216	160	100	8.5	176
36	38	229	176	110	8.5	176
38	40	241	184	115	10.5	292
40	42	254	192	120	10.5	320
42	45	305	240	150	10.5	364

C



S-6134

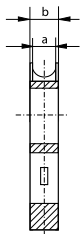
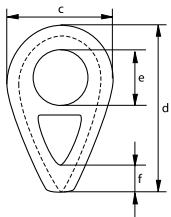

Thimbles

According to DIN 3091

- **Material:** cast mild steel, (GTW 40)
- **Standard:** according to DIN 3091
- **Finish:** self-coloured
- **Certification:** 2.1 CE II B
- **Note:** the diameter (e) of the thimble for diameter wire rope 72 mm is 140 mm

diameter rope	width groove	width overall	width	length	diameter	length	weight per 100 pcs
mm	a mm	b mm	c mm	d mm	e mm	f mm	kg
8	9	15	40	56	14	-	18
10	11	17.5	50	70	18	-	32
12	13	20	60	84	21	-	52
14	16	23.5	70	98	25	-	80
16	18	26	80	130	28	16	90
18	20	28.5	90	145	31	18	121
20	22	31	100	161	35	20	161
22	24	33.5	110	177	38	22	211
24	26	36	120	193	41	24	271
26	29	39.5	130	209	44	26	355
28	31	42	140	224	47	28	420
32	35	47	160	256	53	32	630
36	40	53	180	288	59	36	884
40	44	58	200	320	65	40	1100
44	48	63	220	352	70	44	1500
48	53	69	240	384	76	48	2000
52	57	74	260	416	81	52	2500
56	62	80	280	448	86	56	3200
64	70	90	320	512	95	64	4600
72	79	101	360	576	140	72	6600



E-6135
G-6135

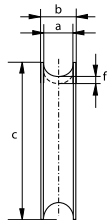
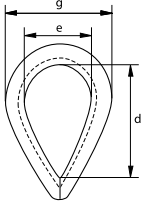

Thimbles

Generally to DIN 3090

- **Material:** mild steel
- **Standard:** generally to DIN 3090
- **Finish:** for diameter 4 and 6 mm electro-galvanized
other diameters hot dipped galvanized
- **Certification:** 2.1 CE II B

diameter wire rope	width groove	width overall	length	length inside	width inside	thickness back	width	weight per 100 pcs
mm	a mm	b mm	c mm	d mm	e mm	f mm	g mm	kg
4	5	8	35	20	10	2.1	25	1.40
6	7	10	50	30	15	2.6	33	3
8	9	13	68	40	20	4	43	7.10
10	11	15	77	50	25	5	47	17
12	13	19	100	60	30	6	63	24
14	16	22	110	70	35	8	70	31
16	18	25	125	80	40	8	80	50
18	20	27	142	90	45	9	90	62
20	22	30	155	100	50	10	102	90
22	24	33	165	110	55	10	107	100
24	26	35	180	120	60	10	120	130
26	29	36	190	130	65	12	122	220
28	31	37	197	140	70	12	128	240
32	35	43	225	160	80	15	145	216
36	40	60	250	180	90	15	170	430
40	44	66	290	200	100	20	190	570
44	48	72	315	220	110	20	205	850
48	53	77	350	240	120	20	220	1120
52	57	88	380	260	130	25	235	1530
56	62	95	405	280	140	25	270	2148
60	66	105	430	300	150	25	285	2300
64	70	110	485	320	160	30	310	3500

C

Thimbles

Generally to EN 13411-1

- **Material:** mild steel
- **Standard:** generally to EN 13411-1 formerly BS 464
- **Finish:** hot dipped galvanized
- **Certification:** 2.1 CE IIB



G-6170

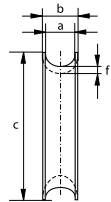
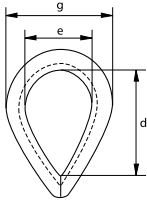

diameter rope		width groove	width overall	length	length inside	width inside	thickness back	width	weight per 100 pcs
inch	mm	a mm	b mm	c mm	d mm	e mm	f mm	g mm	kg
3/16	5	6	9.5	47	27	18	3	32	3.50
1/4	7	7	11	51	33	20.5	3.5	36	2.80
5/16	8	8	12.7	52	33	22	4	38	5.70
3/8	10	10	14.3	64	38	25	6.3	47.6	8
7/16	11	13	17.5	73	41	29	7.9	52	14.2
1/2	13	14	20.6	79	45	32	7.9	58.8	18
9/16	14	15	20.6	88	56	38	7.9	64	18.9
5/8	16	16	22.2	96	59	41	8.7	74.5	22.4
11/16	17	19	28.6	108	67	45	9.5	79.4	39.7
3/4	19	21	28.6	124	73	51	11.1	92	45.6
7/8	22	22	31.7	131	83	56	12.7	102	61.5
15/16	24	25	33.4	146	92	64	12.7	110	106
1	25	27	35	162	108	70	14.3	119	97.3
1 1/8	29	29	38	178	112	76	15.9	133	151
1 1/4	32	33	41.3	197	133	95	15.9	152	204
1 3/8	35	38	47.6	228	152	105	19	175	318
1 1/2	38	41	52	254	165	114	23.8	197	363
1 5/8	41	47	57	280	188	120	24	205	499
1 3/4	44	51	57	286	178	127	25.4	228	556
1 7/8	48	60	66.6	317	190	133	28.6	248	-
2	51	64	69.8	330	203	140	30.1	257	-
2 1/8	54	64	69.8	330	203	140	30.1	257	-
2 1/4	57	67	76.2	356	246	160	31.7	296	-
2 1/2	64	75	93	420	255	170	43	300	-



G-6142

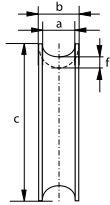
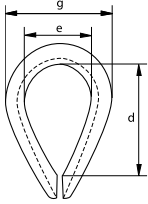

Thimbles

Generally to US Fed. Spec. FF-T-276b type III

- **Material:** mild steel
- **Standard:** generally to US Federal Specification FF-T-276b type III and generally to EN 13411-1
- **Finish:** hot dipped galvanized
- **Certification:** 2.1 CE IIB

diameter rope	width groove	width overall	length	length inside	width inside	thickness back	width	weight per 100 pcs
mm	a mm	b mm	c mm	d mm	e mm	f mm	g mm	kg
6	7	10	56	41	22	1.5	38	2.70
8	8	12.6	64	48	27	2	46	5.10
9	10	17.2	73	54	26	2.5	54	9.10
11	12	18	83	60	32	3	60	13.9
13	13.6	21.4	92	70	38	4	70	19.9
14	15	23	92	70	38	4	68	20.5
16	16.8	24.5	103	83	44	4	78	29.8
19	19.8	31.8	127	95	51	6	97	60.8
22	24	36	140	108	57	6	108	80.4
25	27	39	156	114	63	6	125	109
28 - 32	34	46	178	130	73	6	148	147
32 - 35	36	56	228	165	89	10	173	366
35 - 38	39	63	228	158	89	12	181	478
41	42	66	285	203	101	12	206	731
45	45	69	309	228	114	12	216	778
48 - 51	54	78	380	305	152	12	250	1150
57	60	92	435	356	178	16	301	1935
64	70	110	465	360	178	20	310	2640
76	85	125	550	410	180	20	330	3850



G-6151

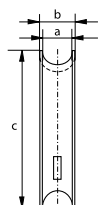
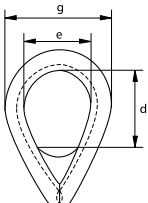

Thimbles

Pennant line type

- **Material:** mild steel
- **Finish:** hot dipped galvanized produced with a welded fillet plate
- **Certification:** 2.1 CE IIB

diameter wire rope	width groove	width overall	length	length inside	width inside	width	weight each
mm	a mm	b mm	c mm	d mm	e mm	g mm	kg
16	17	22	102	50	50	75	0.40
18	19	25	114	50	53	85	0.50
20	21	29	127	60	60	100	0.80
22	23	33	140	60	65	110	0.90
24	25	34	152	70	70	115	1
28	30	38	178	75	80	135	1.70
30	33	44	203	80	100	155	2.50
36	38	49	229	110	115	175	4
40	41	52	254	120	120	190	4.50
44	46	60	279	120	130	210	7
50	52	65	305	140	145	245	8.30
56	60	72	356	155	155	260	12.5
64	70	84	432	200	190	310	19.5
76	81	119	483	235	230	350	29
82	92	130	559	240	255	395	35
90	105	145	610	275	280	430	42
120	120	155	660	295	285	450	58

C

Thimbles

Tubular type

- **Material:** mild steel
- **Finish:** painted
- **Certification:** 2.1 CE IIB



P-6190

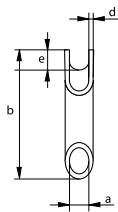

diameter wire rope	diameter	length	width inside	thickness	height	weight each
mm	a mm	b mm	c mm	d mm	e mm	kg
10	12	90	23	4	8	0.23
12	15	105	27	5	10	0.40
14	17	115	27	5	10	0.50
16	19	120	32	5	12	0.60
18	22	140	35	5	15	0.75
22	25	180	45	6	16	1.40
24	28	180	45	7	16	1.75
26	30	195	47	7	18	2
32	35	215	60	7	22	2.50
38	45	260	70	7	27	3.50
44	50	280	75	7	28	4.20

C

Thimbles

Tubular type with welded plate

- **Material:** mild steel
- **Finish:** painted
- **Certification:** 2.1 CE IIB



P-6195

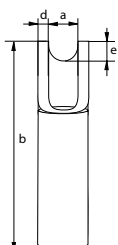
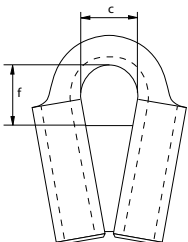

diameter wire rope	width groove	length	width inside	thickness	height	length inside	weight each
mm	a mm	b mm	c mm	d mm	e mm	f mm	kg
10	12	84	23	4	8	24	0.26
12	15	95	27	5	10	31	0.42
14	17	100	27	5	10	38	0.48
16	19	112	32	5	12	46	0.61
18	22	125	35	5	15	47	0.95
22	25	150	45	6	16	61	1.33
24	28	157	45	7	16	56	1.67
26	30	170	47	7	18	68	1.96
32	35	190	60	7	22	73	2.43
36	40	212	70	9	26	80	4.32
38	45	228	70	7	27	94	3.67