

C

Rigging screws Eye-Eye

According to DIN 1480

- **Material:** drop forged mild steel
- **Standard:** DIN 1480
- **Finish:** electro-galvanized
- **Certification:** 2.1



E-6351

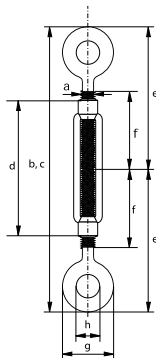

diameter thread	length closed position	length open position	length body	length end fitting	length thread	diameter eye outside	diameter eye inside	weight each
a mm	b mm	c mm	d mm	e mm	f mm	g mm	h mm	kg
5	114	170	70	57	35	16	8	0.07
6	160	246	110	80	55	20	9	0.11
8	168	248	110	84	57	22	10	0.2
10	210	300	125	105	68	31	14	0.28
12	222	305	125	110	70	35	16	0.43
14	244	334	140	123	75	40	18	0.61
16	300	416	170	143	88	47	22	1
20	334	466	200	165	105	52	24	1.60
22	372	527	220	185	118	60	27	2.20
24	410	587	255	208	135	65	27	2.80
30	440	605	255	220	135	71	31	4.10
33	490	690	295	245	148	88	36	6
36	554	740	295	277	158	94	38	8.50
42	600	800	330	300	170	110	49	11

C

Rigging screws Hook-Hook

According to DIN 1480

- **Material:** drop forged mild steel
- **Standard:** DIN 1480
- **Finish:** electro-galvanized
- **Certification:** 2.1



E-6352

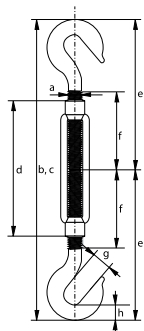

diameter thread	length closed position	length open position	length body	length end fitting	length thread	opening hook	thickness hook	weight each
a mm	b mm	c mm	d mm	e mm	f mm	g mm	h mm	kg
6	184	270	110	92	55	8	15	0.11
8	200	280	110	100	57	10.5	15	0.20
10	234	323	125	117	68	13	11	0.28
12	260	343	125	130	70	16	13	0.43
14	278	368	140	139	75	18	15	0.61
16	322	438	170	161	88	20	17	1
20	382	514	200	191	105	21	21	1.60
22	456	601	220	228	118	24	28	2.20
24	496	673	255	248	135	26	33	2.80
30	550	715	255	275	135	34	35	4.10
33	600	799	295	300	148	38	40	6
36	640	825	295	320	158	46	45	8.30

C

Rigging screws Eye-Hook

According to DIN 1480

- **Material:** drop forged mild steel
- **Standard:** DIN 1480
- **Finish:** electro-galvanized
- **Certification:** 2.1



E-6354

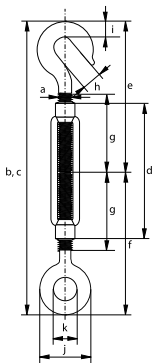

diameter thread	length closed position	length open position	length body	length end fitting	length end fitting	length thread	opening hook	thickness hook	diameter eye outside	diameter eye inside	weight each
a mm	b mm	c mm	d mm	e mm	f mm	g mm	h mm	i mm	j mm	k mm	kg
5	125	180	70	56	57	35	7	12	16	8	0.07
6	172	258	110	77	80	55	8	15	20	9	0.11
8	184	264	110	85	84	57	10.5	15	22	10	0.20
10	222	311	125	106	105	68	13	11	31	14	0.28
12	241	324	125	117	111	70	16	13	35	16	0.43
14	261	351	140	124	122	75	18	15	40	18	0.61
16	311	427	170	144	150	88	20	17	47	22	1
20	358	490	200	170	167	105	21	21	52	24	1.60
22	414	559	220	200	186	118	24	28	60	27	2.20
24	453	630	255	215	205	135	26	33	65	27	2.80
30	495	660	255	240	220	135	34	35	71	31	4.10
33	545	744	295	260	245	148	38	40	88	36	6
36	597	782	295	275	277	158	46	45	94	38	8.40

C

Rigging screws Jaw-Jaw

According to DIN 1480

- **Material:** drop forged mild steel
- **Standard:** DIN 1480
- **Finish:** electro-galvanized
- **Note:** supplied with locking nuts
- **Certification:** 2.1



E-6353

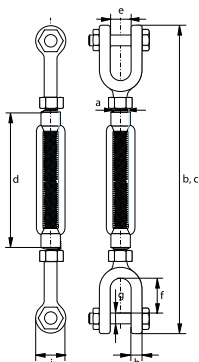

diameter thread	length closed position	length open position	length body	opening jaw	length inside	diameter pin	thickness jaw eye	diameter jaw eye	weight each
a mm	b mm	c mm	d mm	e mm	f mm	g mm	h mm	i mm	kg
6	191	277	110	7.5	12	M 6	5	13	0.16
8	194	274	110	8.5	12	M 6	6	14	0.21
10	236	325	125	11	16	M 8	8	18	0.38
12	266	349	125	13	20	M 10	10	24	0.66
14	316	406	140	16	30	M 12	12	28	1.15
16	374	490	170	18	38	M 12	12	32	1.45
20	438	570	200	20	42	M 16	16	38	2.61
22	466	611	220	22	44	M 18	18	40	3.24
24	514	691	255	24	46	M 20	20	42	4.35
30	544	709	255	30	50	M 24	22	46	6.48

C

Rigging screws with Welding Ends

According to DIN 1480

- **Material:** drop forged mild steel
- **Standard:** DIN 1480
- **Finish:** Body: electro-galvanized
Welding ends: self-coloured
- **Certification:** 2.1



E-6355

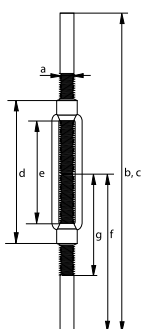

diameter thread	length closed position	length open position	length body	length body inside	length stub-ends	length thread	weight per 100 pcs
a mm	b mm	c mm	d mm	e mm	f mm	g mm	kg
6	240	326	110	86	120	65	9.30
8	240	320	110	80	120	65	14
10	300	389	125	89	150	75	29
12	300	383	125	83	150	75	40
14	330	420	140	90	165	85	66
16	400	516	170	116	200	100	89
20	440	572	200	132	220	120	160
22	440	585	220	145	220	130	227
24	520	697	255	177	260	150	282
30	520	685	255	165	260	160	423
36	600	780	295	185	300	180	710

C

Turnbuckles (hamburgers)

For deck lashing

- **Material:** mild steel
- **Finish:** self-coloured
- **Certification:** 2.1



S-6330



minimum breaking load	diameter thread	length thread	diameter bow	length bow	weight each
t	a mm	b mm	c mm	d mm	kg
13	24	400	16	210	2.80
18	27	400	18	210	4.40
20	30	400	20	210	5
21	36	400	20	210	7

C

Closed body rigging screws Jaw-Jaw

- **Material:** mild steel
- **Safety factor:** MBL equals 5 x WLL,
- **Finish:** hot dipped galvanized
- **Certification:** 2.1 2.2 CE IIA
- **Note:** end fittings of 6 and 8 mm rigging screws are electro-galvanized



G-6343

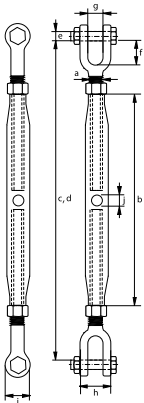

working load limit	diameter thread	length body	length closed position	length open position	diameter pin	length inside	opening jaw	width jaw	diameter jaw eye	diameter hole	weight each
t	a mm	b mm	c mm	d mm	e mm	f mm	g mm	h mm	i mm	j mm	kg
0.2	6	100	170	250	5	19	7	20	13	6	0.15
0.32	8	108	199	279	6	25	9	24	14	8	0.26
0.5	10	125	222	312	8	26	10.5	28	19	8	0.45
0.7	12	195	315	470	10	32	13	34	23	10	0.85
1.2	16	230	388	568	12	39	18	42	29	11	1.51
1.5	20	270	449	654	16	46	20	51	33	12	2.62
2.2	22	295	490	715	20	55	25	55	38	12	3.94
3.2	24	325	538	793	22	63	30	70	46	12	5.16
4.8	33	370	680	965	30	85	38	82	60	14	11.6
6	39	400	707	1002	33	86	45	85	76	15	14.2
8.5	45	400	761	1011	39	105	50	94	85	16	20.8
11	48	400	780	1005	45	119	58	98	92	16	24

C

Closed body rigging screws Eye-Eye

- **Material:** mild steel
- **Safety factor:** MBL equals 5 x WLL,
- **Finish:** hot dipped galvanized
- **Certification:** 2.1 2.2 CE IIA
- **Note:** end fittings of 6 and 8 mm rigging screws are electro-galvanized



G-6340

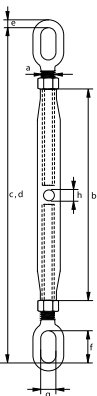

working load limit	diameter thread	length body	length closed position	length open position	diameter	length eye inside	width eye inside	diameter hole	weight each
t	a mm	b mm	c mm	d mm	e mm	f mm	g mm	h mm	kg
0.2	6	100	160	240	5.5	11	11	6	0.12
0.32	8	108	175	255	6	12	12	8	0.19
0.5	10	125	205	300	8.5	13	13	8	0.34
0.7	12	195	298	458	11	19	15	10	0.77
1.2	16	230	356	531	12	28	20	11	1.31
1.5	20	270	423	628	16	34	24	12	2.36
2.2	22	295	463	688	16	34	24	12	2.94
3.2	24	325	502	752	19	37	28	12	3.86
4.8	33	370	602	882	29	41	35	14	8.95
6	39	400	651	951	35	45	40	15	11
8.5*	45	400	721	897	31	49	49	16	13.4
11*	48	400	767	1032	37	52	52	16	17.9

* Different design

C

Closed body rigging screws Eye-Jaw

- **Material:** mild steel
- **Safety factor:** MBL equals 5 x WLL,
- **Finish:** hot dipped galvanized
- **Certification:** 2.1 2.2 CE IIA
- **Note:** end fittings of 6 and 8 mm rigging screws are electro-galvanized



G-6345

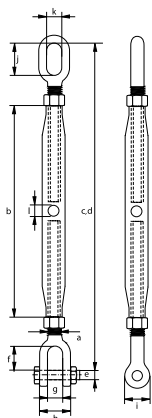

working load limit	diameter thread	length body	length closed position	length open position	diameter pin	length jaw inside	opening jaw	width jaw	diameter jaw eye	length eye inside	width eye inside	diameter hole	weight each
t	a mm	b mm	c mm	d mm	e mm	f mm	g mm	h mm	i mm	j mm	k mm	l mm	kg
0.2	6	100	165	245	5	19	7	20	13	11	11	6	0.14
0.32	8	108	187	267	6	25	9	24	14	12	12	8	0.24
0.5	10	125	214	306	8	26	10.5	28	19	13	13	8	0.53
0.7	12	195	307	464	10	32	13	34	23	19	15	10	0.83
1.2	16	230	372	549	12	39	18	42	29	28	20	11	1.49
1.5	20	270	436	641	16	46	20	51	33	34	24	12	2.54
2.2	22	295	477	701	20	55	25	55	38	34	24	12	3.34
3.2	24	325	520	772	22	63	30	70	46	37	28	12	4.65
4.8	33	370	641	923	30	85	38	82	60	41	35	14	10.5
6	39	400	679	976	33	86	45	85	76	45	40	15	12.8
8.5*	45	400	741	945	39	105	50	94	85	49	49	16	20.8
11*	48	400	774	1018	45	119	58	98	92	52	52	16	24

* Different design



Open body rigging screws Hook-Hook

- Material: AISI 316
- Finish: polished
- Certification: 2.1



R-7837

diameter thread	length closed position	length open position	length body	length	length	length	opening hook	thickness	weight each
a mm	b mm	c mm	d mm	e mm	f mm	g mm	h mm	mm	kg
M5	120	170	70	58	33	8	5	0.04	
M6	150	210	90	73	43	9	6	0.08	
M8	200	290	120	98	56	11	8	0.16	
M10	240	355	150	117	71	12	9	0.27	
M12	310	470	200	157	95	14	11	0.51	
M16	390	590	250	186	116	16	15	1.20	
M20	440	675	300	214	139	18	19	1.90	

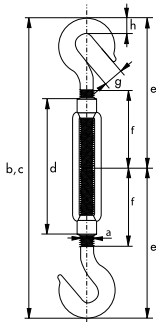

Open body rigging screws Hook-Eye

- Material: AISI 316
- Finish: polished
- Certification: 2.1



R-7838

diameter thread	length closed position	length open position	length body	length	length	length	opening hook	thickness	diameter eye outside	diameter eye inside	weight each
a mm	b mm	c mm	d mm	e mm	f mm	g mm	h mm	i mm	j mm	k mm	kg
M5	120	170	70	58	56	33	8	5	17	8	0.04
M6	150	210	90	73	71	43	9	6	21	10	0.08
M8	200	290	120	98	95	56	11	8	28	14	0.16
M10	240	355	150	117	118	71	12	9	34	16	0.27
M12	310	470	200	157	154	95	14	11	40	18	0.51
M16	390	590	250	186	190	116	16	15	54	26	1.20
M20	440	675	300	214	220	139	18	19	64	30	1.90

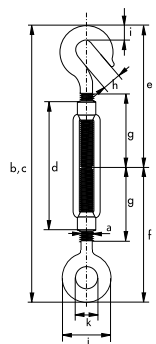

C

Open body rigging screws Eye-Eye

- Material: AISI 316
- Finish: polished
- Certification: 2.1



R-7839

diameter thread	length closed position	length open position	length body	length	length	diameter eye outside	diameter eye inside	weight each
a mm	b mm	c mm	d mm	e mm	f mm	g mm	h mm	kg
M5	120	170	70	56	33	17	8	0.04
M6	150	210	90	71	43	21	10	0.08
M8	200	290	120	95	56	28	14	0.16
M10	240	355	150	118	71	34	16	0.27
M12	310	470	200	154	95	40	18	0.51
M16	390	590	250	190	116	54	26	1.20
M20	440	675	300	220	139	64	30	1.90

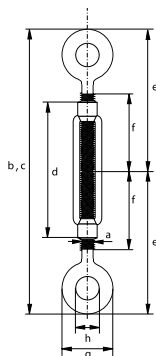

C

Closed body rigging screws Jaw-Jaw

- Material: AISI 316
- Finish: polished
- Certification: 2.1



R-7830

diameter thread	length open	length closed	length body	diameter pin	width jaw inside	weight per 100 pcs
a mm	b mm	c mm	d mm	e mm	f mm	kg
M5	190	125	80	5.2	6	6.50
M6	210	155	95	6.2	7.5	8.10
M8	240	180	105	8.7	10	15.9
M10	270	220	125	9.7	12	29.9
M12	360	255	150	12.7	14	53.2
M14	385	270	165	12.7	14	64
M16	450	320	190	16	16	116
M20	450	355	210	19	20	145

