

# LIFTING CLAMPS



## Applications

Lifting Clamps are used for lifting and transportation of all kinds of steel plates and beams.

## Range

Green Pin® offers a wide range of lifting clamps for horizontal and/or vertical lifting of steel plates and beams ranging from WLL 0.75 t up to 25 t. They can handle steel plates with a thickness up to 150 mm. Upon request other types of clamps can be manufactured.

## Design

Four different designs have been developed:

- P-6615, for lifting and vertical transportation of steel plates;
- P-6635, for horizontal transportation of steel plates;
- P-6625, a universal type for transportation in all directions;
- P-6685, for transportation of steel beams.

All of these types are also available as BigMouth® versions, which have a larger opening.

All types of lifting clamps are generally marked with:

- |  |                      |
|--|----------------------|
| • Working Load Limit                   | - e.g. 3000 kg       |
| • manufacturer's identification symbol | - Green Pin®         |
| • type                                 | - 3 U                |
| • jaw opening in mm                    | - e.g. 35 mm         |
| • serial number                        | - e.g. E 12031976B64 |
| • CE conformity code                   | - CE                 |

## Finish

The lifting clamps are made of carbon and alloy steel and are painted.

## Certification

Specific details of certificate availability can be found on each product page. Please verify your certification requirements at the time of order.

## Instructions for use

Lifting clamps should be inspected before use to ensure that:

- all markings are legible;
- a clamp with the correct WLL has been selected;
- always make sure that the clamp is supporting the load correctly;
- the WLL should be applied in-line;
- overloads are not permitted;
- the locking lever or any other locking system cannot vibrate out of position;
- lifting clamps are free from nicks, gouges and cracks;
- clamps may not be heat treated as this may affect their WLL;
- never modify, repair or reshape a clamp by machining, welding, heating or bending as this may affect the WLL.

For more detailed instructions for use, we refer to the instructions in the FAQ section on our website [www.greenpin.com/FAQ](http://www.greenpin.com/FAQ).

Lifting clamps must be regularly inspected in accordance with the safety standards and regulations given in the country of use. This is required because the products in use may be affected by wear, misuse, overloading etc. which may lead to deformation and alteration of the material structure. Inspection should take place at least every six months (follow the local rules in the country of use) and more frequently when the clamps are used in severe operating conditions.

### Lifting clamps P-6615 and P-6616

Full load may be applied up to a load direction angle of maximum 45°. Load reduction should be applied as per load direction angle and corresponding remaining percentage of the Working Load Limit. Do not side load the lifting eye.

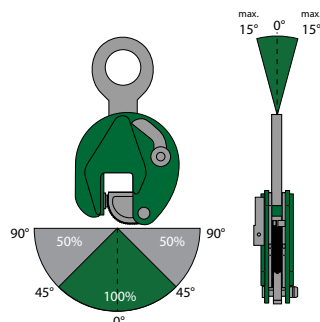

### Lifting clamps P-6625 and P-6626

Full load may be applied up to a load direction angle of maximum 45°. Load reduction should be applied as per load direction angle and corresponding remaining percentage of the Working Load Limit. Do not side load the lifting eye.

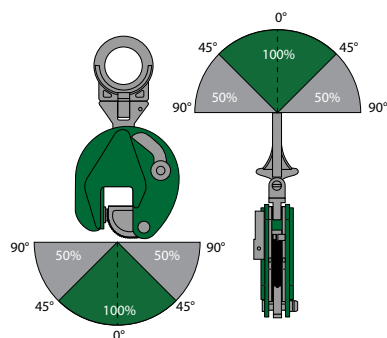

### Lifting clamps P-6635 and P-6636, 100% WLL

Full load may be applied up to a load direction angle of maximum 30°. Do not use larger angles.

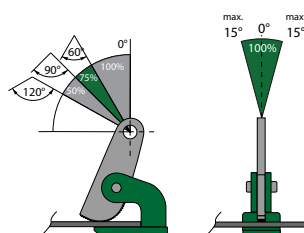

### Lifting clamps P-6685 and P-6686, 100% WLL

Full load may be applied up to a load direction angle of maximum 15°. Do not use larger angles.

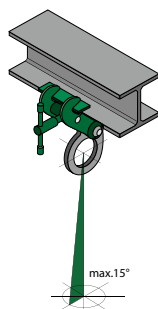



P-6615

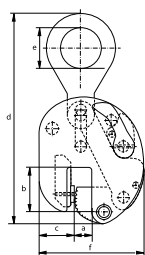

P-6616

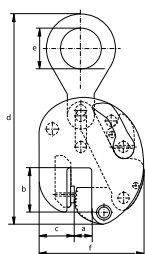

## Green Pin® Lifting Clamp V-type

Plate clamp for lifting and vertical transportation

- **Material:** carbon and alloy steel
- **Safety factor:** MBL equals 5 x WLL
- **Standard:** generally to EN 13155, ASME B30.20-2010 and AS 4991
- **Finish:** painted
- **Temperature range:** -40 °C up to +100 °C
- **Certification:** 2.1 2.2 MTC<sup>a</sup> CE IIA
- **Article code:** scan QR code to see article codes

Scan for additional product details



type	working load limit	width opening	length opening	width	length	diameter inside eye	width	thickness	thickness	weight each
	t	a mm	b mm	c mm	d mm	e mm	f mm	g mm	h mm	kg
0.75 V	0.75	0-13	47	37	202	30	100	37	10	1.70
1 V	1	0-25	56	37	263	45	141	47	15	3.50
2 V	2	0-35	78	56	336	64	183	56	16	7
3 V	3	0-35	78	56	336	64	183	56	16	7
4.5 V	4.5	0-45	85	60	425	70	228	78	20	16
6 V	6	0-50	114	82	490	75	259	78	20	21
7.5 V	7.5	0-55	111	70	522	75	267	86	20	26
9 V	9	0-55	111	70	522	75	267	86	20	27
12 V	12	0-52	148	100	617	85	295	94	20	37
15 V	15	0-76	209	136	810	86	373	106	25	70
20 V	20	0-80	250	153	933	100	563	140	30	149

CAD INFO

## Green Pin BigMouth® Lifting Clamp V-type

Plate clamp with enlarged opening for lifting and vertical transportation

- **Material:** carbon and alloy steel
- **Safety factor:** MBL equals 5 x WLL
- **Standard:** generally to EN 13155, ASME B30.20-2010 and AS 4991
- **Finish:** painted
- **Temperature range:** -40 °C up to +100 °C
- **Certification:** 2.1 2.2 MTC<sup>a</sup> CE IIA
- **Article code:** scan QR code to see article codes

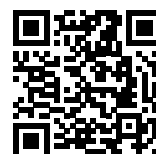

type	working load limit	width opening	length opening	width	length	diameter inside eye	width	thickness	thickness	weight each
	t	a mm	b mm	c mm	d mm	e mm	f mm	g mm	h mm	kg
6 VE	6	40-90	114	70	486	75	275	78	20	21
7.5 VE	7.5	50-100	111	70	524	75	312	86	20	26.5
9 VE	9	50-100	111	70	522	75	312	86	20	27.5
12 VE	12	50-100	152	100	615	85	344	94	20	41
15 VE	15	80-150	224	136	800	86	450	106	25	76
20 VE	20	80-150	249	153	924	100	640	140	30	160

CAD INFO

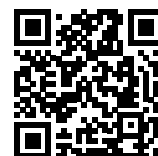

## Green Pin® Lifting Clamp U-type

Universal plate clamp for lifting and transportation in all directions

- **Material:** carbon and alloy steel
- **Safety factor:** MBL equals 5 x WLL
- **Standard:** generally to EN 13155, ASME B30.20-2010 and AS 4991
- **Finish:** painted
- **Temperature range:** -40 °C up to +100 °C
- **Certification:** 2.1 2.2 MTC<sup>3</sup> CE IIA
- **Article code:** scan QR code to see article codes



P-6625

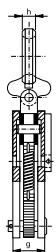
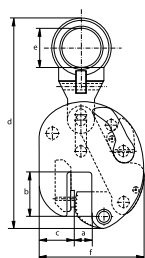

type	working load limit	width opening	length opening	width	length	diameter inside eye	width	thickness	thickness	weight each
	t	a mm	b mm	c mm	d mm	e mm	f mm	g mm	h mm	kg
0.75 U	0.75	0-13	47	37	203	30	100	37	10	1.80
2 U	2	0-35	78	56	372	70	183	56	16	8
3 U	3	0-35	78	56	372	70	183	56	16	8
6 U	6	0-50	114	82	527	78	259	78	32	24
7.5 U	7.5	0-55	111	70	560	78	267	86	32	28
9 U	9	0-55	111	70	560	78	267	86	32	29
12 U	12	0-52	148	100	648	85	295	94	48	41

CAD INFO



## Green Pin BigMouth® Lifting Clamp U-type

Universal plate clamp for transportation in all directions and with enlarged opening

- **Material:** carbon and alloy steel
- **Safety factor:** MBL equals 5 x WLL
- **Standard:** generally to EN 13155, ASME B30.20-2010 and AS 4991
- **Finish:** painted
- **Temperature range:** -40 °C up to +100 °C
- **Certification:** 2.1 2.2 MTC<sup>3</sup> CE IIA
- **Article code:** scan QR code to see article codes



P-6626

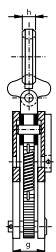
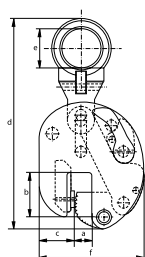

type	working load limit	width opening	length opening	width	length	diameter inside eye	width	thickness	thickness	weight each
	t	a mm	b mm	c mm	d mm	e mm	f mm	g mm	h mm	kg
6 UE	6	40-90	114	70	523	78	275	78	32	24
7.5 UE	7.5	50-100	111	70	560	78	312	86	32	30
9 UE	9	50-100	111	70	560	78	312	86	32	31
12 UE	12	50-100	152	100	644	85	344	94	48	45

CAD INFO



P-6635

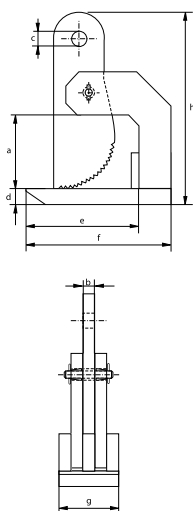

## Green Pin® Lifting Clamp H-Type

### Plate clamp for horizontal transportation

- **Material:** carbon and alloy steel
- **Safety factor:** MBL equals 5 x WLL
- **Standard:** generally to EN 13155, ASME B30.20-2010 and AS 4991
- **Finish:** painted
- **Temperature range:** -40 °C up to +100 °C
- **Certification:** 2.1 2.2 3.1 MTC<sup>a</sup> CE IIA
- **Article code:** scan QR code to see article codes

Scan for additional product details



type	working load limit per set	width opening	thickness	diameter eye	thickness	length	length	width	length	weight each
	t	a mm	b mm	c mm	d mm	e mm	f mm	g mm	h mm	kg
2 H	2	0-60	16	30	15	118	180	90	287	7
3 H	3	0-60	16	30	20	118	180	90	291	8
4 H	4	0-60	20	30	25	145	220	105	304	13
6 H	6	0-60	20	30	25	145	220	110	307	14
8 H	8	0-60	30	30	35	135	225	120	336	19
10 H	10	0-60	30	30	35	135	225	120	336	19
15 H	15	0-60	35	43	35	147	262	160	344	30
25 H	25	0-60	35	43	40	147	262	175	349	33

CAD INFO



P-6636

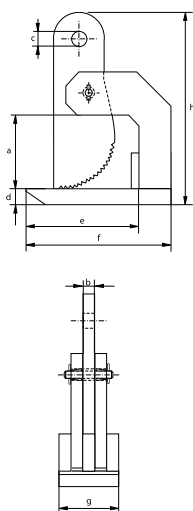

## Green Pin BigMouth® Lifting Clamp H-type

### Plate clamp with an enlarged opening for horizontal transportation

- **Material:** carbon and alloy steel
- **Safety factor:** MBL equals 5 x WLL
- **Standard:** generally to EN 13155, ASME B30.20-2010 and AS 4991
- **Finish:** painted
- **Temperature range:** -40 °C up to +100 °C
- **Certification:** 2.1 2.2 3.1 MTC<sup>a</sup> CE IIA
- **Article code:** scan QR code to see article codes



type	working load limit per set	width opening	thickness	diameter eye	thickness	length	length	width	length	weight each
	t	a mm	b mm	c mm	d mm	e mm	f mm	g mm	h mm	kg
3 HE	3	0-100	15	30	20	120	180	90	387	10
4 HE	4	0-100	20	30	25	145	220	105	414	15
6 HE	6	0-100	20	30	25	145	220	120	414	16.5
8 HE	8	0-100	30	30	35	135	225	120	428	21
10 HE	10	0-100	30	30	35	135	225	120	428	22
15 HE	15	0-150	35	45	35	240	350	140	665	53

CAD INFO

Scan for additional product details

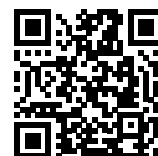

## Green Pin® Beam Lifting Clamp H-type

Clamp for horizontal lifting and transportation of steel beams

- **Material:** carbon and alloy steel
- **Safety factor:** MBL equals 5 x WLL
- **Standard:** generally to EN 13155, ASME B30.20-2010 and AS 4991
- **Finish:** painted
- **Temperature range:** -40 °C up to +100 °C
- **Certification:** 2.1 2.2 MTC<sup>3</sup> CE IIA
- **Article code:** scan QR code to see article codes

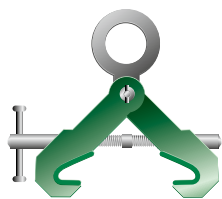

P-6685

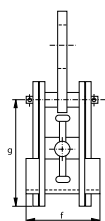
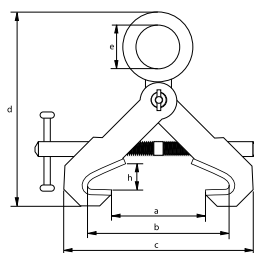

type	working load limit	width jaw opening	width jaw opening	length	height	diameter eye inside	width	thickness	width	weight each
	t	a mm	b mm	c mm	d mm	e mm	f mm	g mm	h mm	kg
2 B	2	0-130	75-190	357	345	73	120	113-192	30	5
3 B	3	0-130	75-190	357	345	73	120	113-192	30	5
4 B	4	0-220	150-300	450	422	80	180	185-240	40	15
5 B	5	0-220	150-300	450	422	80	180	185-240	40	15
10 B	10	0-190	350-450	695	653	88	200	400-447	95	50

CAD INFO



## Green Pin BigMouth® Beam Lifting Clamp H-type

Clamp with enlarged opening for horizontal lifting and transportation of steel beams

- **Material:** carbon and alloy steel
- **Safety factor:** MBL equals 5 x WLL
- **Standard:** generally to EN 13155, ASME B30.20-2010 and AS 4991
- **Finish:** painted
- **Temperature range:** -40 °C up to +100 °C
- **Certification:** 2.1 2.2 MTC<sup>3</sup> CE IIA
- **Article code:** scan QR code to see article codes



P-6686

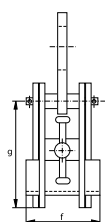
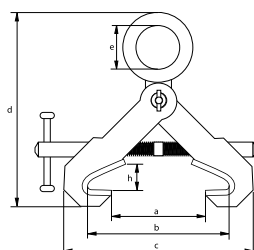

type	working load limit	width jaw opening	width jaw opening	length	height	diameter eye inside	width	thickness	width	weight each
	t	a mm	b mm	c mm	d mm	e mm	f mm	g mm	h mm	kg
2 BE	2	0-350	75-420	540	428	73	120	114-275	30	7
3 BE	3	0-350	75-420	540	428	73	120	114-275	30	7
4 BE	4	0-470	150-560	708	545	80	180	173-362	40	18
5 BE	5	0-470	150-560	708	545	80	180	173-362	40	19.5

CAD INFO

# BLOCKS



## Applications

Blocks are used in lifting systems, to change load direction or to drag a load. Blocks and the wire ropes they contain make a connection between a load and a lifting device.

## Range

Green Pin® offers a wide range of blocks. Blocks are available for head loads ranging from 2 t up to 30 t. Other types of blocks can be offered upon special request.

## Design

There are different types of blocks with specific designs to suit particular purposes. All types are fitted with conical roller bearings. These can be used for applications with different frequency of use and line speeds. Snatch blocks can be opened up to fit the wire rope easily. There is no need to thread the wire rope through the block.

All types are generally marked as follows:

- |                                       |  |
|---------------------------------------|--|
| • Working Load Limit                  | - e.g. 8 t   |
| • manufacturer's symbol               | - e.g. GP  |
| • wire rope diameter in mm and inches | - e.g. 20 - 22 mm and $\frac{3}{4}$ - $\frac{7}{8}$ inch |
| • serial number                       | - e.g. 1234567   |
| • CE conformity code                  | - CE   |

## Finish

Green Pin® Blocks are painted.

## Certification

Specific details of certificate availability can be found on each product page. Please verify your certification requirements at the time of order.

## Instructions for use

Blocks should be inspected before use to ensure that:

- all markings are legible;
- a block with the correct WLL has been selected;
- the WLL applies to static loads only, the possible occurrence of shock loading must be taken into account when selecting a block;
- the block may never be side loaded but may only be used for in-line use;
- always make sure that the hook, eye or shackle of the block is supporting the load correctly;
- the pin, nut, cotter pin, or any other locking system cannot vibrate out of position;
- the sheaves are functional and rotate easily;
- blocks are free from nicks, gouges and cracks;
- blocks may not be heat treated as this may affect their WLL;
- never modify, repair or reshape a block by machining, welding, heating or bending as this may affect the WLL.

Blocks must be regularly inspected in accordance with the safety standards and regulations given in the country of use. This is required because the products in use may be affected by wear, misuse, overloading etc. which may lead to deformation and alteration of the material structure. Inspection should take place at least every six months and more frequently when the blocks are used in severe operating conditions.

## Loads on blocks

The WLLs of our blocks are the maximum loads to be applied to the blocks and their connecting fittings. The load on a sheave or block varies with the angle between the lead and load line. See figure 1. When the two lines are parallel, 1 t on the lead line results in a load of 2 t on the fitting. As the working angle between the lines increases, the load on the fitting is reduced by the angle factor as per table 1. All loads shown ignore frictional losses in the lifting system.

Table 1

working angle	angle factor
0°	2
10°	1.99
20°	1.97
30°	1.93
40°	1.87
45°	1.84
50°	1.81
60°	1.73
70°	1.64
80°	1.53
90°	1.41
100°	1.29
110°	1.15
120°	1
130°	0.84
135°	0.76
140°	0.68
150°	0.52
160°	0.35
170°	0.17
180°	0

Figure 1

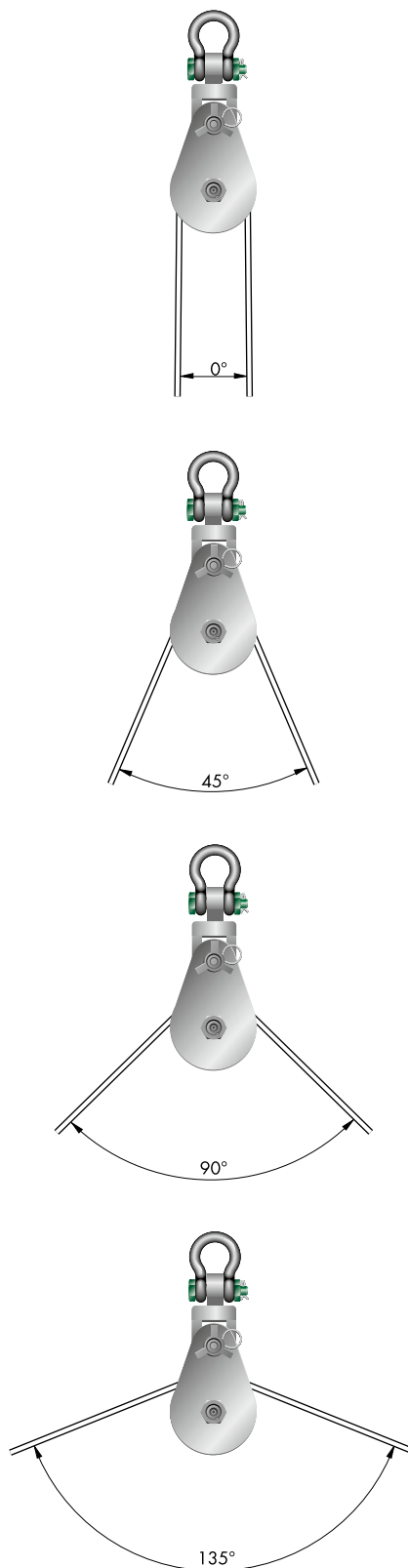





## Green Pin® Snatch Block S

### Snatch block type 601S with Green Pin® Shackle attached

Scan for  
additional  
product  
details

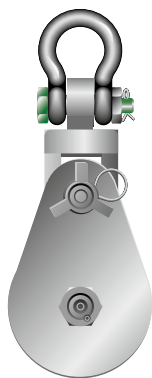

P-6951

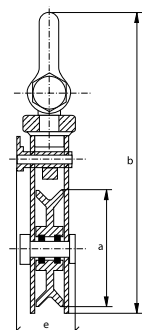
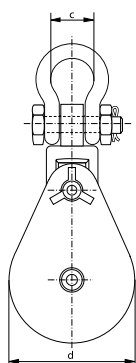

- **Material:** carbon steel, fitted with conical roller bearings
- **Safety factor:** MBL equals 4 x WLL
- **Finish:** painted
- **Certification:** 2.1 2.2 MTC<sup>®</sup> CE IIA
- **Article code:** scan QR code to see article codes
- **Note:** Working Load Limit is on the headfitting

working load limit	diameter wire rope	diameter outside sheave	length	width	width outside	thickness	weight each
t	mm	a mm	b mm	c mm	d mm	e mm	kg
2	7 - 9	75	291	43	82	87	3.87
4	10 - 12	115	363	58	120	89	6.36
4	12 - 14	150	417	58	160	89	8.39
8	20 - 22	150	478	68	160	119	14.1
8	14 - 16	150	478	68	160	119	14.3
12	20 - 22	150	551	83	160	119	20
12	14 - 16	150	551	83	160	119	20
15	24 - 26	150	585	92	160	138	24
4	10 - 12	200	478	58	210	119	11
8	20 - 22	200	527	68	210	119	18
12	20 - 22	200	580	83	210	125	28
12	14 - 16	200	580	83	210	125	27
15	24 - 26	200	646	92	210	142	30
8	20 - 22	250	581	68	260	104	26
8	14 - 16	250	581	68	260	104	26
12	20 - 22	250	679	83	260	125	35
15	24 - 26	250	705	92	260	146	42
8	20 - 22	300	646	68	310	106	31
12	20 - 22	300	748	83	310	146	35
15	24 - 26	300	771	92	310	142	33
8	20 - 22	350	691	68	360	119	31
12	20 - 22	350	773	83	360	145	35
15	24 - 26	350	798	92	365	171	63
22	28 - 32	350	950	126	365	180	94
8	20 - 22	400	756	68	415	119	35
12	20 - 22	400	822	83	415	170	67
15	24 - 26	400	848	92	415	170	39
22	28 - 32	405	1007	126	415	180	139
30	32 - 38	405	1076	138	415	210	124
8	20 - 22	450	817	68	465	119	42
12	20 - 22	450	877	83	465	170	75
15	24 - 26	450	898	92	465	170	44.5
22	28 - 32	450	1057	126	465	180	154
30	28 - 32	450	1101	138	465	210	218
32	28 - 35	399	1361	138	409	193	140
32	28 - 38	450	1444	138	470	193	161
32	28 - 38	495	1511	138	511	193	170
36	28 - 38	495	1575	160	511	203	228
32	28 - 32	594	1669	138	610	193	170
54	38 - 51	594	1861	180	610	269	348
75	44 - 51	594	2105	190	610	266	391
75	44 - 57	749	2442	190	770	266	636
100	64 - 67	800	2681	238	820	260	838
125	70 - 76	889	2898	275	919	260	1158

CAD

## Green Pin® Snatch Block HK

### Snatch block type 601H with hook attached

Scan for  
additional  
product  
details

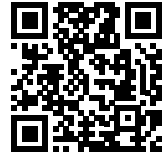

- **Material:** carbon steel, fitted with conical roller bearings
- **Safety factor:** MBL equals 4 x WLL
- **Finish:** painted
- **Certification:** 2.1 2.2 MTC<sup>®</sup> CE IIA
- **Article code:** scan QR code to see article codes
- **Note:** Working Load Limit is on the headfitting

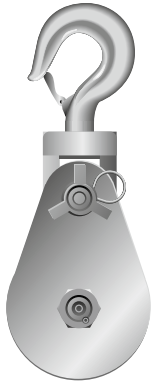

P-6952

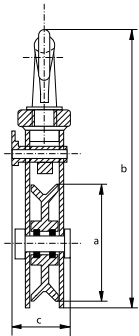
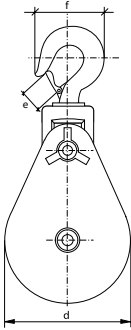

working load limit	diameter wire rope	diameter outside sheave	length	thickness	width outside	opening hook	width outside	weight each
t	mm	a mm	b mm	c mm	d mm	e mm	f mm	kg
2	7 - 9	75	290	87	82	30	108	3.68
4	10 - 12	115	358	89	120	43	132	6
4	12 - 14	150	412	89	160	43	132	8.50
8	20 - 22	150	502	119	160	45	165	11.8
12	20 - 22	150	616	119	160	71	226	20.5
15	24 - 26	150	626	138	160	71	226	23.4
4	10 - 12	200	473	91	210	43	132	8
8	20 - 22	200	551	119	210	45	165	20.4
12	20 - 22	200	641	129	210	71	226	30
15	24 - 26	200	663	142	210	71	226	29.5
8	20 - 22	250	606	103	260	45	165	25.4
12	20 - 22	250	728	125	260	71	226	35.5
15	24 - 26	250	745	166	260	71	226	41
8	20 - 22	300	671	119	310	45	165	32
12	20 - 22	300	810	166	310	71	226	50
15	24 - 26	300	810	166	310	71	226	52
8	20 - 22	350	716	119	360	45	165	38
12	20 - 22	350	835	166	360	71	226	59
15	24 - 26	350	837	166	360	71	226	58.5
8	20 - 22	400	780	119	415	45	165	48
12	20 - 22	400	888	166	415	71	226	36
15	24 - 26	400	890	166	415	71	226	68.5
8	20 - 22	450	841	119	465	45	165	58
12	20 - 22	450	942	166	465	71	226	42
15	24 - 26	450	942	166	465	71	226	82

CAD



P-6953

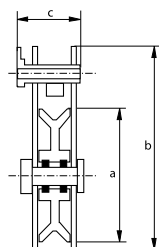
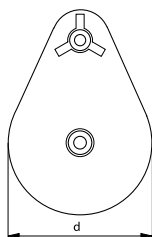

## Green Pin® Snatch Block

### Snatch block type 601T

- **Material:** carbon steel, fitted with conical roller bearings
- **Safety factor:** MBL equals 4 x WLL
- **Finish:** painted
- **Certification:** 2.1 2.2 MTC<sup>®</sup> CE IIA
- **Article code:** scan QR code to see article codes
- **Note:** Working Load Limit is on the headfitting

Scan for  
additional  
product  
details



working load limit	diameter wire rope	diameter outside sheave	length	thickness	width outside	weight each
t	mm	a mm	b mm	c mm	d mm	kg
4	10 - 12	115	189	80	120	4
8	20 - 22	150	268	105	160	9.50
8	20 - 22	200	322	105	210	12
8	20 - 22	254	377	105	260	18

CAD

