

C

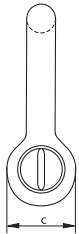

G-3161

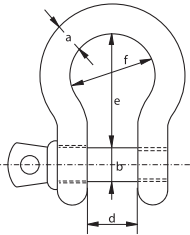

Yellow Pin Shackles

Bow shackle with screw collar pin

- **Material:** bow and pin high tensile steel, grade 6
- **Standard:** generally to US Fed. Spec. RR-C-271
- **Finish:** hot dipped galvanized
- **Certification:** 2.1 2.2 CE
- **Note:** import quality

working load limit	diameter bow	diameter pin	diameter eye	width inside	length inside	width bow	weight each
t	a mm	b mm	c mm	d mm	e mm	f mm	kg
0.33	5	6	14	9.5	22	15	0.03
0.5	6	8	16	12	29	20	0.05
0.75	8	10	19	13.5	31	21	0.08
1	10	11	23	17	37	26	0.14
1.5	11	13	27	19	43	29	0.2
2	13	16	30	20	48	33	0.33
3.25	16	19	38	27	60	43	0.62
4.75	19	22	46	32	71	50	1.07
6.5	22	25	53	36	84	58	1.62
8.5	25	28	61	43	95	68	2.28
9.5	28	32	68	46	108	74	3.36
12	32	35	76	51	119	82	4.31
13.5	35	38	84	57	133	92	6.14
17	38	42	92	60	146	98	7.81
25	45	50	106	73	177	127	12.61

C

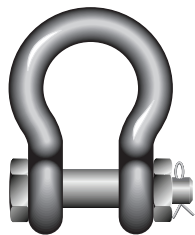

G-3163

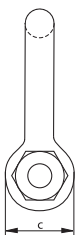
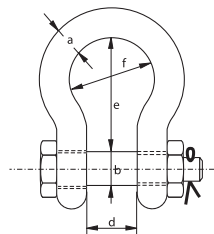

Yellow Pin Shackles

Bow shackle with safety bolt

- **Material:** bow and pin high tensile steel, grade 6
- **Standard:** generally to US Fed. Spec. RR-C-271
- **Finish:** hot dipped galvanized
- **Certification:** 2.1 2.2 CE
- **Note:** import quality

working load limit	diameter bow	diameter pin	diameter eye	width inside	length inside	width bow	weight each
t	a mm	b mm	c mm	d mm	e mm	f mm	kg
2	13	16	30	20	48	33	0.36
3.25	16	19	38	27	60	43	0.7
4.75	19	22	46	32	71	50	1.1
6.5	22	25	53	36	84	58	1.61
8.5	25	28	61	43	95	68	2.42
9.5	28	32	68	46	108	74	3.35
12	32	35	76	51	119	82	5.32
13.5	35	38	84	57	133	92	7.19
17	38	42	92	60	146	98	9.44
25	45	50	106	73	177	127	13.8

C

Yellow Pin Shackles

Dee shackle with screw collar pin

- **Material:** bow and pin high tensile steel, grade 6
- **Standard:** generally to US Fed. Spec. RR-C-271
- **Finish:** hot dipped galvanized
- **Certification:** 2.1 2.2 CE
- **Note:** import quality



G-3151

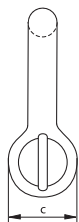
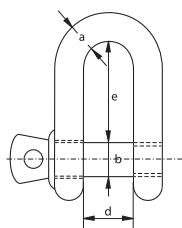

working load limit	diameter bow	diameter pin	diameter eye	width inside	length inside	weight each
t	a mm	b mm	c mm	d mm	e mm	kg
0.33	5	6	12	9.5	19	0.03
0.5	6	8	16	12	22	0.04
0.75	8	10	19	13.5	26	0.08
1	10	11	23	17	32	0.13
1.5	11	13	27	19	37	0.2
2	13	16	30	20	41	0.28
3.25	16	19	38	27	51	0.57
4.75	19	22	46	32	60	1.19
6.5	22	25	53	36	71	1.43
8.5	25	28	61	43	81	2.16
9.5	28	32	68	46	90	3.06
12	32	35	76	51	100	4.11
13.5	35	38	84	57	111	5.28
17	38	42	92	60	122	6.69
25	45	50	106	73	146	12.14

C

Yellow Pin Shackles

Dee shackle with safety bolt

- **Material:** bow and pin high tensile steel, grade 6
- **Standard:** generally to US Fed. Spec. RR-C-271
- **Finish:** hot dipped galvanized
- **Certification:** 2.1 2.2 CE
- **Note:** import quality



G-3153

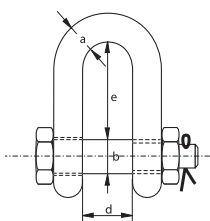

working load limit	diameter bow	diameter pin	diameter eye	width inside	length inside	weight each
t	a mm	b mm	c mm	d mm	e mm	kg
2	13	16	30	20	41	0.33
3.25	16	19	38	27	51	0.62
4.75	19	22	46	32	60	1.02
6.5	22	25	53	36	71	1.49
8.5	25	28	61	43	81	2.26
9.5	28	32	68	46	90	3.2
12	32	35	76	51	100	4.91
13.5	35	38	84	57	111	5.84
17	38	42	92	60	122	8.4
25	45	50	106	73	146	11.9

C

Thimbles

Standard commercial

- Material: mild steel
- Finish: electro-galvanized
- Certification: 2.1



E-6110

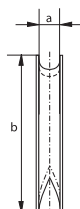
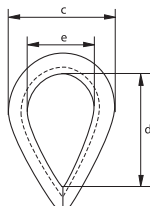

diameter rope	width groove	length	width	length inside	width inside	weight per 100 pcs
mm	a mm	b mm	c mm	d mm	e mm	kg
3	3	24	18	15	10	0.4
4	4	25	19	16	11	0.5
5	5	31	22	22	16	0.8
6	6	37	29	26	19	1.4
8	8	51	38	34	24	2.8
9	9	57	42	38	29	3
10	10	64	44	42	32	4.8
11	11	70	51	48	35	7.5
12	12	76	57	51	38	8
14	14	82	60	57	40	10
16	16	89	64	60	42	15
18	18	102	69	67	45	22
20	20	115	79	76	51	25
22	22	127	89	83	54	32
24	24	140	102	88	64	46
26	26	152	105	102	68	66
28	28	165	115	110	73	77
30	30	178	121	115	79	80
32	32	203	133	140	93	130

C

Thimbles

Heavy duty stub-end

- Material: mild steel
- Finish: hot dipped galvanized
- Certification: 2.1



G-6120

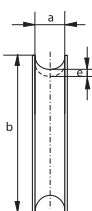
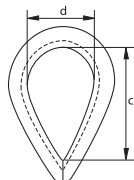

diameter rope	width groove	length	length inside	width inside	thickness back	weight per 100 pcs
mm	a mm	b mm	c mm	d mm	e mm	kg
8	9	51	37	23	4	6
10	11	64	53	31	4	7
12	13	76	60	36	5	14
14	15	89	68	46	6	22
16	17	102	79	51	6	24
18	19	114	90	55	8	43
20	21	127	98	62	9	65
22	23	140	112	67	10	93
24	25	152	119	72	10	102
28	29	178	135	82	10.5	135
32	33	203	163	102	10.5	162
36	37	229	185	117	12	363
40	42	254	205	122	12	376
44	46	280	220	133	15	608
50	52	305	221	143	20	960
56	58	356	252	163	20	1400
64	67	407	286	185	20	1700



G-6128

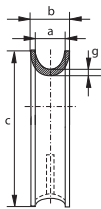
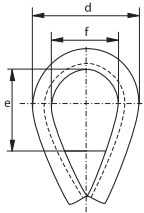

Thimbles

Heavy duty stub-end reinforced with welded fillet plate

- **Material:** mild steel
- **Finish:** hot dipped galvanized reinforced with a welded fillet plate
- **Certification:** 2.1

width groove	width overall	length	width	length inside	width inside	thickness back	weight per piece
a mm	b mm	c mm	d mm	e mm	f mm	g mm	kg
35	55	220	150	100	80	10	3.2
40	65	245	160	120	90	12	5.1
50	80	290	200	125	110	16	9.2
62	100	360	250	160	140	20	17.4
72	115	390	265	175	160	20	19.4
85	125	470	300	245	190	20	29
100	150	540	370	290	200	25	39
115	165	570	380	300	210	25	52

For shackle

group	width groove								
	a mm								
	35	40	50	62	72	85	100	115	
G-4161	17, 25	25	35, 42.5	55	85				
G-4163	17, 25	25	35, 42.5	55	85				
G-4151	17, 25	25	35, 42.5	55	85				
G-4153	17, 25	25	35, 42.5	55	85				
P-6036						120, 150	150, 200		
G-6038						120, 150	150, 200		
P-6033	30	30	40, 55	75	125	125			
G-5263	30, 40	40		85	120	150, 175	175		
G-5163	17, 25	25	35, 42.5	55	85				
P-6031						120, 150	150, 200		
G-4263	4.75 ~ 25	6.5 ~ 25	9.5 ~ 30	16 ~ 55	25 ~ 75	30 ~ 75	55, 75	75	
P-5363	17, 25	25	35, 42.5	55	85				
P-5365	17, 25	25	35, 42.5	55	85	120, 150	150, 200		
P-5367	17, 25	25	35, 42.5	55	85	120, 150	150		
G-4164	17, 25	25							
G-4154	17, 25	25							
G-4169	17								
G-4159	17								

C

Thimbles

Generally to DIN 6899 (B)

- **Material:** mild steel
- **Standard:** generally to DIN 6899 (B)
- **Finish:** thimbles for rope diameters up to and including 6 mm are electro-galvanized, other diameters are hot dipped galvanized
- **Certification:** [2.1](#)



E-6131
G-6131

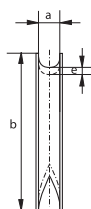
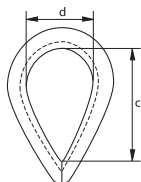

diameter rope	width groove	length	length inside	width inside	thickness back	weight per 100 pcs
mm	a mm	b mm	c mm	d mm	e mm	kg
2.5	3	22	19	12	1.6	0.6
3.5	4	26	21	13	1.6	0.8
4	5	32	23	14	1.9	1
5	6	38	25	16	2.4	2
6	7	44	28	18	2.4	2
7	8	51	32	20	2.8	2.7
9	10	57	38	24	3.1	4.1
11	12	64	45	28	3.3	6.9
13	13	70	48	30	3.3	7.2
13	14	76	51	32	3.7	10.2
15	16	83	58	36	3.8	16.4
16	17	89	61	38	4.7	19
17	18	95	64	40	4.7	20.3
18	20	102	72	45	5.7	27.3
20	22	114	80	50	5.7	30.8
22	24	127	90	56	6.5	44.8
24	26	140	99	62	6.8	59.2
26	28	152	112	70	8	72
28	30	165	120	75	8	104
30	32	178	128	80	8	115
32	34	203	152	95	8.5	153
34	36	216	160	100	8.5	176
36	38	229	176	110	8.5	176
38	40	241	184	115	10.5	292
40	42	254	192	120	10.5	320
42	45	305	240	150	10.5	364
47	50	360	265	160	12	535
57	60	380	275	170	12	790
63	65	420	300	180	13	830
72	75	460	350	200	15	1200
87	90	500	370	210	18	2600
97	100	550	380	220	20	3050



S-6134

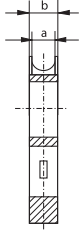
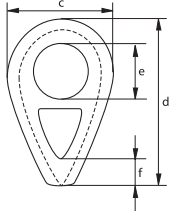

Thimbles

According to DIN 3091

- **Material:** cast mild steel, (GTW 40)
- **Standard:** according to DIN 3091
- **Finish:** self coloured
- **Certification:** 2.1
- **Note:** the diameter (e) of the thimble for diameter wire rope 72 mm is 140 mm

diameter rope	width groove	width overall	width	length	diameter	length	weight per 100 pcs
mm	a mm	b mm	c mm	d mm	e mm	f mm	kg
8	9	15	40	66	14	-	18
10	11	17.5	50	82	18	-	32
12	13	20	60	98	21	-	52
14	16	23.5	70	114	25	-	80
16	18	26	80	130	28	16	90
18	20	28.5	90	145	31	18	121
20	22	31	100	161	35	20	161
22	24	33.5	110	177	38	22	211
24	26	36	120	193	41	24	271
26	29	39.5	130	209	44	26	355
28	31	42	140	224	47	28	420
32	35	47	160	256	53	32	630
36	40	53	180	288	59	36	884
40	44	58	200	320	65	40	1100
44	48	63	220	352	70	44	1500
48	53	69	240	384	76	48	2000
52	57	74	260	416	81	52	2500
56	62	80	280	448	86	56	3200
64	70	90	320	512	95	64	4600
72	79	101	360	576	140	72	6600

C

Thimbles

Generally to DIN 3090



- **Material:** mild steel
- **Standard:** generally to DIN 3090
- **Finish:** for diameter 4 and 6 mm electro-galvanized
other diameters hot dipped galvanized
- **Certification:** 2.1

E-6135
G-6135

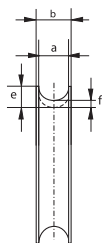
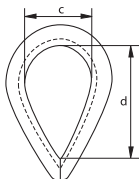

diameter wire rope	width groove	width overall	width inside	length inside	thickness	thickness back	weight per 100 pcs
mm	a mm	b mm	c mm	d mm	e mm	f mm	kg
4	5	9	10	20	5.1	2.1	1.4
6	7	12	15	30	7.1	2.6	3
8	9	13	20	40	11	4	7.1
10	11	16	25	50	14	5	17
12	13	19	30	60	16	6	24
14	16	22	35	70	17	7	31
16	18	25	40	80	19	8	50
18	20	27	45	90	21	9	62
20	22	32	50	100	23	10	90
22	24	33	55	110	24	10	100
24	26	37	60	120	27	11	130
26	29	46	65	130	30	12	220
28	31	50	70	140	33	12	240
32	35	55	80	160	38	14	216
36	40	60	90	180	42	16	430
40	44	65	100	200	46	18	570
44	48	70	110	220	53	20	850
48	53	75	120	240	58	22	1120
52	57	80	130	260	64	25	1530
56	62	85	140	280	67	25	2148
60	66	90	150	300	70	25	2300
64	70	95	160	320	78	30	3500
68	75	100	170	340	81	30	3700
72	79	105	180	360	84	30	4100
76	84	115	190	380	87	30	4600
80	88	120	200	400	90	30	5400



Thimbles

Generally to EN 13411-1

- **Material:** mild steel
- **Standard:** generally to EN 13411-1 formerly BS 464
- **Finish:** hot dipped galvanized
- **Certification:** 2.1



G-6170

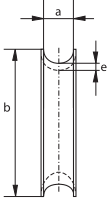
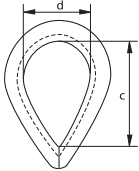

diameter rope		width groove	length	length inside	width inside	thickness back	weight per 100 pcs
inch	mm	a mm	b mm	c mm	d mm	e mm	kg
³ / ₁₆	5	5.5	44	28	19	3	3.5
¹ / ₄	7	6	48	30	20	3.5	2.8
⁵ / ₁₆	8	8	54	33	22	4	5.7
³ / ₈	10	10	64	38	25	4.8	8
⁷ / ₁₆	11	13	73	41	29	4.8	14.2
¹ / ₂	13	14	80	44	32	5.6	18
⁹ / ₁₆	15	15	80	44	32	5.6	18.9
⁵ / ₈	16	17	98	59	41	7.9	22.4
¹¹ / ₁₆	17	19	108	67	44	7.9	39.7
³ / ₄	19	20	124	73	51	9.5	45.6
¹³ / ₁₆	21	21	124	73	51	9.5	62.4
⁷ / ₈	22	23	133	83	57	9.5	61.5
¹⁵ / ₁₆	24	25	146	92	64	10.3	106
1	25	27	162	108	70	10.3	97.3
1 ¹ / ₈	28	29	178	111	76	12.7	151
1 ¹ / ₄	32	33	197	133	95	12.7	204
1 ³ / ₈	35	38	229	152	105	15.9	318
1 ¹ / ₂	38	41	254	165	114	17.5	363
1 ⁵ / ₈	42	46	254	165	114	17.5	499
1 ³ / ₄	45	51	286	178	127	25.4	556
1 ⁷ / ₈	47	60	318	191	133	28.6	-
2	50	64	330	203	140	28.6	-
2 ¹ / ₈	54	64	330	203	140	28.6	-
2 ¹ / ₄	57	67	356	216	146	30.2	-
2 ¹ / ₂	65	70	413	241	159	31.8	-
2 ³ / ₄	70	86	502	273	203	41.3	-

C

Thimbles

Generally to US Fed. Spec. FF-T-276b type III

- **Material:** mild steel
- **Standard:** generally to US Federal Specification FF-T-276b type III and generally to EN 13411-1
- **Finish:** hot dipped galvanized
- **Certification:** 2.1



G-6142

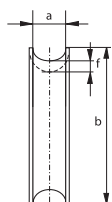
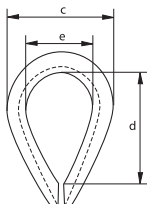

diameter rope	width groove	length	width	length inside	width inside	thickness back	weight per 100 pcs
mm	a mm	b mm	c mm	d mm	e mm	f mm	kg
6	7	55.5	38	41	22	1.6	2.7
8	9	63.5	46	47.5	27	2	5.1
9	10	73	54	54	28.5	2.8	9.1
11	12	82.5	60	60	32	3.2	13.9
13	13.5	92	70	70	38	3.6	19.9
14	15	92	68	70	38	3.6	20.5
16	16.5	108	79	82.5	44.5	4	29.8
19	20	127	97	95	51	5.5	60.8
22	24	140	108	108	57	5.5	80.4
25	27	156	125	114	63.5	6.3	109
28 - 32	30	178	149	130	73	6.3	147
32 - 35	33	205	173	159	89	12.7	366
35 - 38	36.5	229	181	165	89	12.7	478
41	43.5	286	206	203	102	12.7	731
45	47	310	216	229	114	12.7	778
48 - 51	50	384	264	305	152	12.7	1150
57	59.5	435	302	356	178	12.7	1935
64	66	464	311	378	178	19	2640
76	78.5	514	356	419	200	19	3850

In inch

diameter rope	width groove	length	width	length inside	width inside	thickness back	weight per 100 pcs
inch	a inch	b inch	c inch	d inch	e inch	f inch	lbs
1/4	9/32	2 3/16	1 1/2	1 5/8	7/8	1/16	5.9
5/16	11/32	2 1/2	1 13/16	1 7/8	1 1/16	5/64	11.2
3/8	13/32	2 7/8	2 1/8	2 1/8	1 1/8	7/64	20.1
7/16	15/32	3 1/4	2 3/8	2 3/8	1 1/4	1/8	30.6
1/2	17/32	3 5/8	2 3/4	2 3/4	1 1/2	9/64	43.9
9/16	19/32	3 5/8	2 11/16	2 3/4	1 1/2	9/64	45.2
5/8	21/32	4 1/4	3 1/8	3 1/4	1 3/4	5/32	65.7
3/4	25/32	5	3 13/16	3 3/4	2	7/32	134
7/8	15/16	5 1/2	4 1/4	4 1/4	2 1/4	7/32	177
1	1 1/16	6 1/8	4 15/16	4 1/2	2 1/2	1/4	241
1 1/8 - 1 1/4	1 3/16	7	5 7/8	5 1/8	2 7/8	1/4	324
1 1/4 - 1 3/8	1 5/16	8 1/16	6 13/16	6 1/4	3 1/2	1/2	807
1 3/8 - 1 1/2	1 7/16	9	7 1/8	6 1/2	3 1/2	1/2	1054
1 5/8	1 23/32	11 1/4	8 1/8	8	4	1/2	1612
1 3/4	1 27/32	12 3/16	8 1/2	9	4 1/2	1/2	1715
1 7/8 - 2	1 31/32	15 1/8	10 3/8	12	6	1/2	2535
2 1/4	2 11/32	17 1/8	11 7/8	14	7	1/2	4266
2 1/2	2 19/32	18 1/4	12 1/4	14 7/8	7	3/4	5820
3	3 3/32	20 1/4	14	16 1/2	7 7/8	3/4	8488

C



G-6151

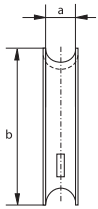
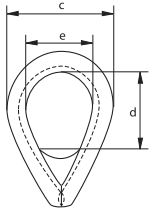

Thimbles

Pennant line type

- **Material:** mild steel
- **Finish:** hot dipped galvanized produced with a welded fillet plate
- **Certification:** 2.1

diameter wire rope	width groove	length	width	length inside	width inside	weight each
mm	a mm	b mm	c mm	d mm	e mm	kg
16	17	102	75	50	50	0.4
18	19	114	85	50	53	0.5
20	21	127	100	60	60	0.8
22	23	140	110	60	65	0.9
24	25	152	115	70	70	1
28	30	178	135	75	80	1.7
30	33	203	155	80	100	2.5
36	38	229	175	110	115	4
40	41	254	190	120	120	4.5
44	46	279	210	120	130	7
50	52	305	225	140	140	8.3
56	60	356	240	150	150	12.5
64	70	432	290	185	180	19.5
76	81	483	320	225	220	29
82	92	559	375	280	240	35
90	105	610	410	280	250	42
120	120	660	450	280	280	58

C

Thimbles

Tubular type

- Material: mild steel
- Finish: painted
- Certification: 2.1



P-6190

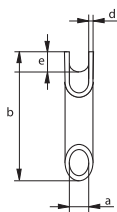

diameter wire rope	diameter	length	width inside	thickness	height	weight each
mm	a mm	b mm	c mm	d mm	e mm	kg
10	12	90	23	4	8	0.23
12	15	105	27	5	10	0.4
14	17	115	27	5	10	0.5
16	19	120	32	5	12	0.6
18	22	140	35	5	15	0.75
22	25	180	45	6	16	1.4
24	28	180	45	7	16	1.75
26	30	195	47	7	18	2
32	35	215	60	7	22	2.5
36	40	212	70	9	36	3
38	45	260	70	7	27	3.5
44	50	280	75	7	28	4.2

C

Thimbles

Tubular type with welded plate

- Material: mild steel
- Finish: painted
- Certification: 2.1



P-6195

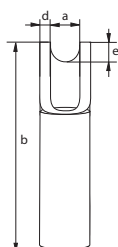
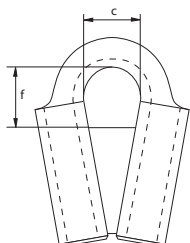

diameter wire rope	width groove	length	width inside	thickness	height	length inside	weight each
mm	a mm	b mm	c mm	d mm	e mm	f mm	kg
10	12	84	23	4	8	24	0.26
12	15	95	27	5	10	31	0.42
14	17	100	27	5	10	38	0.48
16	19	112	32	5	12	46	0.61
18	22	125	35	5	15	47	0.95
22	25	150	45	6	16	61	1.33
24	28	157	45	7	16	56	1.67
26	30	170	47	7	18	68	1.96
32	35	190	60	7	22	73	2.43
36	40	212	70	9	26	80	4.32
38	45	228	70	7	27	94	3.67

C



E-6260

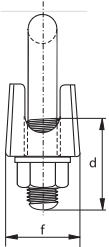
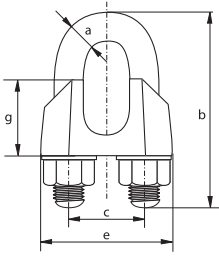

Wire Rope Clip

Generally to EN 13411-5 Type A

- **Material:** bridge: malleable steel
U-bolt: mild steel
- **Standard:** EN 13411-5 Type A
formerly DIN 1142
- **Finish:** electro-galvanized
- **Certification:** 2.1

diameter wire rope	diameter a	length bow b	width inside c	length thread d	length base e	thickness base f	height base g	weight per 100 pcs
mm	mm	mm	mm	mm	mm	mm	mm	kg
5	5	25	12	14	25	13	13	2
6.5	6	32	14	17	30	16	14	4
8	8	41	18	20	39	20	18	8.2
10	8	46	20	24	40	20	21	8.4
12	10	56	24	28	50	25	24	17
13	12	64	29	29	55	28	29	27.5
14	12	66	28	31	59	30	28	28.6
16	14	76	34	35	64	32	35	43
19	14	83	37	36	68	33	40	49
22	16	96	41	40	74	34	44	68
26	20	111	46	50	84	38	51	111
30	20	127	54	55	95	41	59	140
34	22	141	60	60	105	45	67	202
40	24	159	68	65	117	49	77	268

C

Wire Rope Clip

Generally to DIN 741



E-6220

- **Material:** bridge: casted
U-bolt: mild steel
- **Standard:** formerly DIN 741
- **Finish:** electro-galvanized
- **Certification:** 2.1

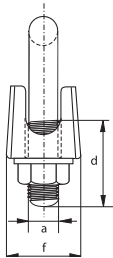
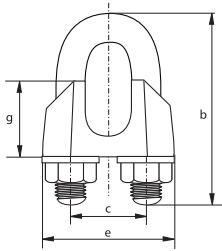

diameter wire rope	diameter	length bow	width inside	length thread	length base	thickness base	height base	weight per 100 pcs
mm	a mm	b mm	c mm	d mm	e mm	f mm	g mm	kg
3	4	20	9	12	21	10	10	1.4
5	5	24	11	13	23	11	10	1.5
6	5	28	13	15	26	12	11	1.6
8	6	34	16	19	30	14	15	4.1
10	8	42	19	22	34	18	17	6
11	8	44	20	22	36	19	18	7
13	10	55	24	30	42	23	21	11.8
14	10	57	25	30	44	23	22	12.4
16	12	63	29	33	50	26	26	21
19	12	75	32	38	54	29	30	23.6
22	14	85	37	44	61	33	34	23.8
26	14	95	41	45	65	35	37	41
30	16	110	48	50	74	37	43	62
34	16	120	52	55	80	42	50	75
40	16	140	58	60	88	45	55	104
45	18	163	65	75	97	49	60	134
50	20	170	72	77	106	51	65	175



E-6351

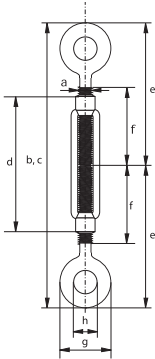

Rigging screws Eye-Eye

According to DIN 1480

- **Material:** drop forged mild steel
- **Standard:** DIN 1480
- **Finish:** electro-galvanized
- **Certification:** **2.1**

diameter thread	length closed position	length open position	length body	length end fitting	length thread	diameter eye outside	diameter eye inside	weight each
a mm	b mm	c mm	d mm	e mm	f mm	g mm	h mm	kg
5	114	170	70	57	35	16	8	0.07
6	160	246	110	80	55	20	9	0.11
8	168	248	110	84	57	22	10	0.2
10	210	300	125	105	68	31	14	0.28
12	222	305	125	110	70	35	16	0.43
14	244	334	140	123	75	40	18	0.61
16	300	416	170	143	88	47	22	1
20	334	466	200	165	105	52	24	1.6
22	372	527	220	185	118	60	27	2.2
24	410	587	255	208	135	65	27	2.8
30	440	605	255	220	135	71	31	4.1
33	490	690	295	245	148	88	36	6
36	554	740	295	277	158	94	38	8.5
42	600	800	330	300	170	110	49	11



E-6352

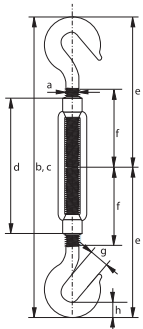

Rigging screws Hook-Hook

According to DIN 1480

- **Material:** drop forged mild steel
- **Standard:** DIN 1480
- **Finish:** electro-galvanized
- **Certification:** **2.1**

diameter thread	length closed position	length open position	length body	length end fitting	length thread	opening hook	thickness hook	weight each
a mm	b mm	c mm	d mm	e mm	f mm	g mm	h mm	kg
6	184	270	110	92	55	8	15	0.11
8	200	280	110	100	57	10.5	15	0.2
10	234	323	125	117	68	13	11	0.28
12	260	343	125	130	70	16	13	0.43
14	278	368	140	139	75	18	15	0.61
16	322	438	170	161	88	20	17	1
20	382	514	200	191	105	21	21	1.6
22	456	601	220	228	118	24	28	2.2
24	496	673	255	248	135	26	33	2.8
30	550	715	255	275	135	34	35	4.1
33	600	799	295	300	148	38	40	6
36	640	825	295	320	158	46	45	8.3

C

Rigging screws Eye-Hook

According to DIN 1480

- **Material:** drop forged mild steel
- **Standard:** DIN 1480
- **Finish:** electro-galvanized
- **Certification:** [2.1](#)



E-6354

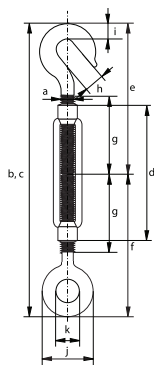

diameter thread	length closed position	length open position	length body	length end fitting	length end fitting	length thread	opening hook	thickness hook	diameter eye outside	diameter eye inside	weight each
a mm	b mm	c mm	d mm	e mm	f mm	g mm	h mm	i mm	j mm	k mm	kg
5	125	180	70	56	57	35	7	12	16	8	0.07
6	172	258	110	77	80	55	8	15	20	9	0.11
8	184	264	110	85	84	57	10.5	15	22	10	0.2
10	222	311	125	106	105	68	13	11	31	14	0.28
12	241	324	125	117	111	70	16	13	35	16	0.43
14	261	351	140	124	122	75	18	15	40	18	0.61
16	311	427	170	144	150	88	20	17	47	22	1
20	358	490	200	170	167	105	21	21	52	24	1.6
22	414	559	220	200	186	118	24	28	60	27	2.2
24	453	630	255	215	205	135	26	33	65	27	2.8
30	495	660	255	240	220	135	34	35	71	31	4.1
33	545	744	295	260	245	148	38	40	88	36	6
36	597	782	295	275	277	158	46	45	94	38	8.4

C

Rigging screws Jaw-Jaw

According to DIN 1480

- **Material:** drop forged mild steel
- **Standard:** DIN 1480
- **Finish:** electro-galvanized
- **Note:** supplied with locking nuts
- **Certification:** [2.1](#)



E-6353

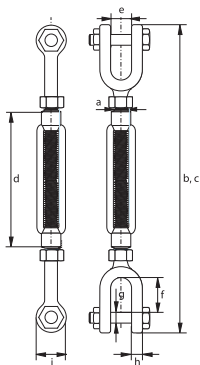

diameter thread	length closed position	length open position	length body	opening jaw	length inside	diameter pin	thickness jaw eye	diameter jaw eye	weight each
a mm	b mm	c mm	d mm	e mm	f mm	g mm	h mm	i mm	kg
6	191	277	110	7.5	12	M 6	5	13	0.16
8	194	274	110	8.5	12	M 6	6	14	0.21
10	236	325	125	11	16	M 8	8	18	0.38
12	266	349	125	13	20	M 10	10	24	0.66
14	316	406	140	16	30	M 12	12	28	1.15
16	374	490	170	18	38	M 12	12	32	1.45
20	438	570	200	20	42	M 16	16	38	2.61
22	466	611	220	22	44	M 18	18	40	3.24
24	514	691	255	24	46	M 20	20	42	4.35
30	544	709	255	30	50	M 24	22	46	6.48

C



E-6355

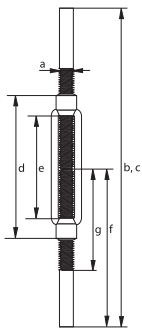

Rigging screws with Welding Ends

According to DIN 1480

- **Material:** drop forged mild steel
- **Standard:** DIN 1480
- **Finish:** Body: electro-galvanized
Welding ends: self coloured
- **Certification:** 2.1

diameter thread	length closed position	length open position	length body	length body inside	length stub-ends	length thread	weight per 100 pcs
a mm	b mm	c mm	d mm	e mm	f mm	g mm	kg
6	240	326	110	86	120	65	9.3
8	240	320	110	80	120	65	14
10	300	389	125	89	150	75	29
12	300	383	125	83	150	75	40
14	330	420	140	90	165	85	66
16	400	516	170	116	200	100	89
20	440	572	200	132	220	120	160
22	440	585	220	145	220	130	227
24	520	697	255	177	260	150	282
30	520	685	255	165	260	160	423
36	600	780	295	185	300	180	710

C

Turnbuckles (hamburgers)

For deck lashing

- **Material:** mild steel
- **Finish:** self coloured
- **Certification:** 2.1



S-6330



minimum breaking load	diameter thread	length thread	diameter bow	length bow	weight each
t	a mm	b mm	c mm	d mm	kg
13	24	400	16	210	2.8
13	24	500	16	260	3.8
18	27	400	18	210	4.4
18	27	500	18	260	5.5
20	30	400	20	210	5
20	30	500	20	260	6.3
21	36	400	20	210	7
21	36	500	20	260	8.8



G-6343

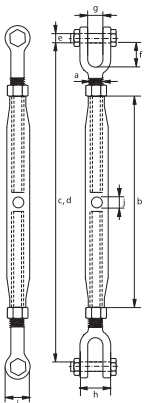

Closed body rigging screws Jaw-Jaw

- **Material:** mild steel
- **Safety factor:** MBL equals 5 x WLL,
- **Finish:** hot dipped galvanized
- **Certification:** 2.1 2.2 CE
- **Note:** end fittings of 6 and 8 mm rigging screws are electro-galvanized

working load limit	diameter thread	length body	length closed position	length open position	diameter pin	length inside	opening jaw	width jaw	diameter jaw eye	diameter hole	weight each
t	a mm	b mm	c mm	d mm	e mm	f mm	g mm	h mm	i mm	j mm	kg
0.2	6	100	170	250	5	16	7	20	13	6	0.15
0.32	8	108	199	279	6	22	9	24	14	8	0.26
0.5	10	125	222	312	8	22	10.5	28	19	8	0.45
0.7	12	195	315	470	10	27	13	34	23	10	0.85
1.2	16	230	388	568	12	33	18	42	29	11	1.51
1.5	20	270	449	654	16	38	20	51	33	12	2.62
2.2	22	295	490	715	20	45	25	55	38	12	3.94
3.2	24	325	538	793	22	52	30	70	46	12	5.16
4.8	33	370	680	965	30	70	38	82	60	14	11.6
6	39	400	707	1002	33	70	45	85	76	15	14.2
8.5	45	400	761	1011	39	86	50	94	85	16	20.8
11	48	400	780	1005	45	97	58	98	92	16	24



G-6340

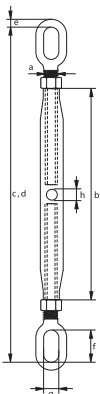

Closed body rigging screws Eye-Eye

- **Material:** mild steel
- **Safety factor:** MBL equals 5 x WLL,
- **Finish:** hot dipped galvanized
- **Certification:** 2.1 2.2 CE
- **Note:** end fittings of 6 and 8 mm rigging screws are electro-galvanized

working load limit	diameter thread	length body	length closed position	length open position	diameter	length eye inside	width eye inside	diameter hole	weight each
t	a mm	b mm	c mm	d mm	e mm	f mm	g mm	h mm	kg
0.2	6	100	160	240	5.5	11	11	6	0.12
0.32	8	108	175	255	6	12	12	8	0.19
0.5	10	125	205	300	8.5	13	13	8	0.34
0.7	12	195	320	480	11	30	15	10	0.77
1.2	16	230	380	555	12	40	20	11	1.31
1.5	20	270	455	660	16	50	24	12	2.36
2.2	22	295	495	720	16	50	24	12	2.94
3.2	24	325	540	790	19	56	28	12	3.86
4.8	33	370	660	940	29	70	35	14	8.95
6	39	400	720	1020	35	80	40	15	11
8.5	45	400	721	879	31	49	49	16	13.4
11	48	400	767	1032	37	52	52	16	17.9

C

Closed body rigging screws Eye-Jaw

- **Material:** mild steel
- **Safety factor:** MBL equals 5 x WLL,
- **Finish:** hot dipped galvanized
- **Certification:** 2.1 2.2 CE
- **Note:** end fittings of 6 and 8 mm rigging screws are electro-galvanized



G-6345

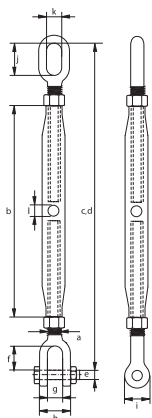

working load limit	diameter thread	length body	length closed position	length open position	diameter pin	length jaw inside	opening jaw	width jaw	diameter jaw eye	length eye inside	width eye inside	diameter hole	weight each
t	a mm	b mm	c mm	d mm	e mm	f mm	g mm	h mm	i mm	j mm	k mm	l mm	kg
0.2	6	100	165	247	5	16	7	20	13	11	11	6	0.14
0.32	8	108	187	267	6	22	9	24	14	12	12	8	0.24
0.5	10	125	214	306	8	22	10.5	28	19	13	13	8	0.53
0.7	12	195	317	475	10	27	13	34	23	30	15	10	0.83
1.2	16	230	384	562	12	33	18	42	29	40	20	11	1.49
1.5	20	270	452	657	16	38	20	51	33	50	24	12	2.54
2.2	22	295	493	717	20	45	25	55	38	50	24	12	3.34
3.2	24	325	539	791	22	52	30	70	46	56	28	12	4.65
4.8	33	370	670	952	30	70	38	82	60	70	35	14	10.5
6	39	400	714	1011	33	70	45	85	76	80	40	15	12.8
8.5	45	400	741	945	39	86	50	94	85	49	49	16	20.8
11	48	400	774	1018	45	97	58	98	92	52	52	16	24

C



E-8140

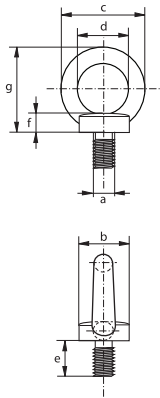

Eye bolts, generally to DIN 580

Generally to DIN 580

- **Material:** carbon steel, C15
- **Safety factor:** MBL equals 6 x WLL
- **Standard:** generally to DIN 580
- **Finish:** electro-galvanized
- **Certification:** 2.1 2.2 CE

working load limit	diameter thread	diameter base	diameter eye outside	diameter eye inside	length	thickness base	height	weight per 100 pcs
t	a mm	b mm	c mm	d mm	e mm	f mm	g mm	kg
0.07	M 6 x 1.00	20	36	20	13	6	36	5.1
0.14	M 8 x 1.25	20	36	20	13	6	36	5.5
0.23	M 10 x 1.50	25	45	25	17	8	45	10.3
0.34	M 12 x 1.75	30	54	30	20.5	10	53	16.9
0.49	M 14 x 2.00	35	63	35	27	12	60	29.9
0.7	M 16 x 2.00	35	63	35	27	12	62	30.7
0.9	M 18 x 2.50	40	72	40	30	14	71	42.8
1.2	M 20 x 2.50	40	72	40	30	14	71	42.4
1.5	M 22 x 2.50	45	81	45	39	14	80	62.8
1.8	M 24 x 3.00	50	90	50	36	18	90	90.8
2.5	M 27 x 3.00	50	90	50	39	18	90	88.3
3.2	M 30 x 3.50	65	108	60	45	22	109	159
4.3	M 33 x 3.50	65	108	60	45	22	110	167
4.6	M 36 x 4.00	75	126	70	54	26	128	235
6.1	M 39 x 4.00	75	126	70	54	26	130	266
6.3	M 42 x 4.50	85	144	80	63	30	147	403
8	M 45 x 4.50	85	144	80	63	35	150	521
8.6	M 48 x 5.00	100	166	90	68	35	168	632
11.5	M 56 x 5.50	110	184	100	78	38	187	879
16	M 64 x 6.00	120	206	110	90	42	208	1240
20	M 72 x 6.00	150	260	140	100	50	260	2293
28	M 80 x 6.00	170	296	160	112	55	298	3200
40	M 100 x 6.00	190	330	180	130	60	330	4800

C

Eye nuts, generally to DIN 582

Generally to DIN 582



- **Material:** carbon steel, C15
- **Safety factor:** MBL equals 6 x WLL
- **Standard:** generally to DIN 582
- **Finish:** electro-galvanized
- **Certification:** 2.1 2.2 CE

E-8142

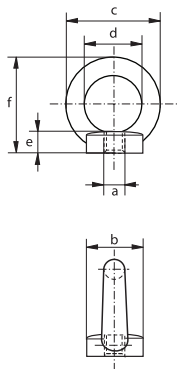

working load limit	diameter thread	diameter base	diameter eye outside	diameter eye inside	thickness base	height	weight per 100 pcs
t	a mm	b mm	c mm	d mm	e mm	f mm	kg
0.07	M 6 x 1.00	20	36	20	8.5	36	5.1
0.14	M 8 x 1.25	20	36	20	8.5	36	5.2
0.23	M 10 x 1.50	25	45	25	10	45	9.4
0.34	M 12 x 1.75	30	54	30	11	53	16
0.49	M 14 x 2.00	35	63	35	13	60	25.5
0.7	M 16 x 2.00	35	63	35	13	62	24
0.9	M 18 x 2.50	40	72	40	16	71	36
1.2	M 20 x 2.50	40	72	40	16	71	35.2
1.5	M 22 x 2.50	45	81	45	18	80	51.7
1.8	M 24 x 3.00	50	90	50	20	90	75.4
2.5	M 27 x 3.00	50	90	50	20	90	102
3.2	M 30 x 3.50	65	108	60	25	109	125
4.3	M 33 x 3.50	65	108	60	25	110	131
4.6	M 36 x 4.00	75	126	70	30	128	208
6.1	M 39 x 4.00	75	126	70	30	130	210
6.3	M 42 x 4.50	85	144	80	35	147	305
8	M 45 x 4.50	85	144	80	35	150	407
8.6	M 48 x 5.00	100	166	90	40	168	502
8.6	M 52 x 5.00	110	184	100	45	187	830
11.5	M 56 x 5.50	110	184	100	45	187	669
16	M 64 x 6.00	120	206	110	50	208	930
21	M 72 x 6.00	150	260	140	60	260	1500

C

Short link chain

Generally to DIN 766 and DIN 5685-3, commercial quality

- **Material:** mild steel, grade 3
- **Standard:** generally to DIN 766 and DIN 5685-3
- **Finish:** electro-galvanized or hot dipped galvanized
- **Certification:** 2.1
- **Note:** not to be used for lifting applications!

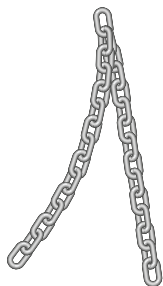

E-7661
G-7662

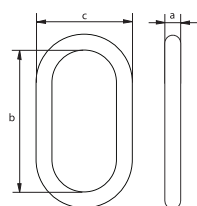

diameter	length inside	length outside	weight per meter
a mm	b mm	c mm	kg
3	16	11	0.17
4	16	14	0.32
5	18.5	17	0.5
6	18.5	20	0.75
7	22	23	1
8	24	26	1.35
9	27	30	1.8
10	28	34	2.25
11	31	36	2.7
13	36	44	3.8
16	45	54	5.8
18	50	60	7.3

C

Long link chain

Generally to DIN 763 and DIN 5685-1, commercial quality

- **Material:** mild steel, grade 3
- **Standard:** generally to DIN 763 and DIN 5685-1
- **Finish:** electro-galvanized or hot dipped galvanized
- **Certification:** 2.1
- **Note:** not to be used for lifting applications!

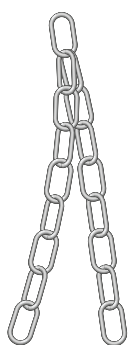

E-7631
G-7632

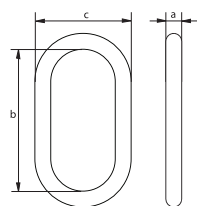

diameter	length inside	length outside	weight per meter
a mm	b mm	c mm	kg
3	26	13	0.14
4	32	16	0.27
5	36	20	0.43
6	42	24	0.63
7	48	28	0.86
8	54	32	1.10
10	66	40	1.75
13	82	50	2.95
16	100	60	4.45

C

Eye bolts

Generally to DIN 580



- **Material:** AISI 316
- **Standard:** generally to DIN 580
- **Finish:** polished
- **Certification:** 2.1

R-7840

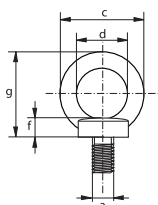

diameter thread	diameter base	diameter eye outside	diameter eye inside	length thread	thickness base	height	weight per 100 pcs
a mm	b mm	c mm	d mm	e mm	f mm	g mm	kg
M 6	20	36	20	13	6	36	3
M 8	20	36	20	13	6	36	6
M 10	25	45	25	17	8	45	10.3
M 12	30	54	30	20.5	10	53	17.7
M 16	35	63	35	27	12	62	28
M 20	40	72	40	30	14	71	45
M 24	50	90	50	36	18	90	74

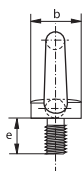

C

Eye nuts

Generally to DIN 582



- **Material:** AISI 316
- **Standard:** generally to DIN 582
- **Finish:** polished
- **Certification:** 2.1

R-7842

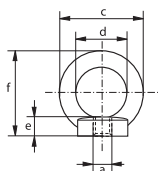

diameter thread	diameter base	diameter eye outside	diameter eye inside	thickness base	height	weight per 100 pcs
a mm	b mm	c mm	d mm	e mm	f mm	kg
M 6	20	36	20	8.5	36	4.2
M 8	20	36	20	8.5	36	5.2
M 10	25	45	25	10	45	9.4
M 12	30	54	30	11	53	14.8
M 16	35	63	35	13	62	23.7

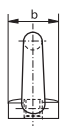

C



MLVI

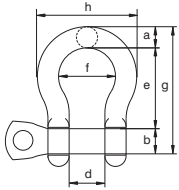

Stainless steel bow shackle with screw pin

- **Material:** AISI 316, grade 5
- **Safety factor:** MBL equals 5 x WLL
- **Finish:** polished
- **Temperature range:** -40°C up to +200°C
- **Certification:** 2.1 2.2 3.1 CE
- **Note:** marked with WLL and CE

working load limit	diameter bow	diameter pin	diameter eye	width inside	length inside	width bow	length	width	weight each
t	a mm	b mm	c mm	d mm	e mm	f mm	g mm	h mm	kg
0.4	8	8	16	16	32	25	56	41	0.06
0.6	10	10	19	20	40	28	67	48	0.12
0.9	12	12	24	25	48	36	79	59	0.2
1.5	13	16	31	24	52	35	87	60	0.32
2.5	16	20	38	28	64	42	108	71	0.58
3	19	22	44	32	72	50	125	87	0.96
4	22	25	50	37	74	60	145	101	1.46
6	25	30	57	40	94	67	157	115	2.09

C



MDVI

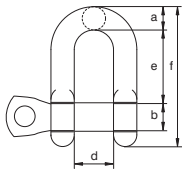

Stainless steel dee shackle with screw pin

- **Material:** AISI 316, grade 5
- **Safety factor:** MBL equals 5 x WLL
- **Finish:** polished
- **Temperature range:** -40°C up to +200°C
- **Certification:** 2.1 2.2 3.1 CE
- **Note:** marked with WLL and CE

working load limit	diameter bow	diameter pin	diameter eye	width inside	length inside	length	weight each
t	a mm	b mm	c mm	d mm	e mm	f mm	kg
0.4	8	8	16	16	32	52	0.06
0.6	10	10	19	20	40	64	0.11
0.9	12	12	24	25	48	78	0.19
1.5	13	16	31	24	52	90	0.3
2.5	16	20	38	28	64	110	0.57
3	19	22	44	32	72	124	0.9
4	22	25	50	37	74	134	1.33
6	25	30	57	40	94	162	1.98

C

Shackles, bow shackles with screw pin

Bow shackles with screw pin



R-7825

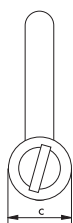
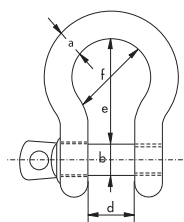

- **Material:** AISI 316
- **Safety factor:** MBL equals 6 x WLL
- **Standard:** generally to DIN 82103
- **Finish:** polished
- **Certification:** 2.1 2.2 3.1 CE
- **Note:** marked with WLL, CE and manufacturer identification symbol (VBS), except for 4 mm as it is too small

working load limit	diameter bow	diameter pin	diameter eye	width inside	length inside	width bow	weight per 100 pcs
t	a mm	b mm	c mm	d mm	e mm	f mm	kg
-	4	4	8	8	16	12	1.2
0.12	5	5	10	10	20	15	1.8
0.15	6	6	12	12	24	18	2.7
0.3	8	8	16	16	32	24	6.3
0.4	10	10	20	20	40	30	12.3
0.6	12	12	24	24	48	36	20.5
1	16	16	32	32	64	48	48
1.5	20	20	40	40	80	60	97
2	22	22	44	44	88	66	146
3	25	25	50	50	100	75	211
3.6	28	28	54	56	116	86	285

C

Shackles, bow shackles with safety bolt

Bow shackles with safety bolt

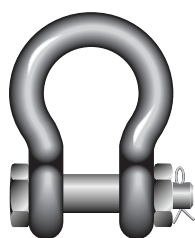

R-7827

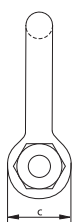
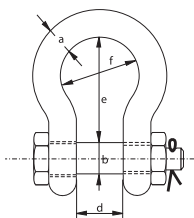

- **Material:** AISI 316
- **Safety factor:** MBL equals 6 x WLL
- **Finish:** polished
- **Certification:** 2.1 2.2 3.1 CE
- **Note:** marked with WLL, CE, traceability code and manufacturer identification symbol (VBS)

working load limit	diameter bow	diameter pin	diameter eye	width inside	length inside	width bow	weight per 100 pcs
t	a mm	b mm	c mm	d mm	e mm	f mm	kg
0.3	8	8	16	16	32	24	7.4
0.4	10	10	19	20	40	30	14.5
0.6	12	12	24	25	49	36	23
1	16	16	31	32	64	48	56.6
1.5	19	19	38	38	80	60	99.5
2	22	22	43	44	85	66	146
3	25	25	49	50	100	75	218

C



R-7821

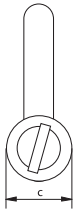
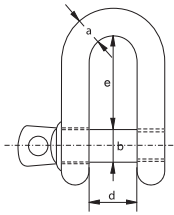

Shackles, dee shackles with screw pin

Dee shackles with screw pin

- **Material:** AISI 316
- **Safety factor:** MBL equals 6 x WLL
- **Standard:** generally to DIN 82102
- **Finish:** polished
- **Certification:** 2.1 2.2 3.1 CE
- **Note:** marked with WLL, CE and manufacturer identification symbol (VBS), except for 4 mm as it is too small

working load limit	diameter bow	diameter pin	diameter eye	width inside	length inside	weight per 100 pcs
t	a mm	b mm	c mm	d mm	e mm	kg
-	4	4	8	8	16	0.9
0.12	5	5	10	10	20	1.6
0.15	6	6	12	12	24	2.6
0.3	8	8	16	16	32	5.6
0.4	10	10	20	20	40	13
0.6	12	12	24	24	48	20
1	16	16	32	32	64	48
1.5	20	20	40	40	80	78
2	22	22	44	44	88	127
3	25	25	50	50	100	184
3.6	28	28	54	56	106	250

C



R-7823

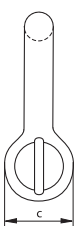
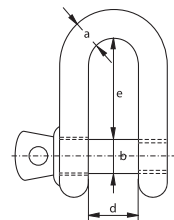

Shackles, dee shackles with safety bolt

Dee shackles with safety bolt

- **Material:** AISI 316
- **Safety factor:** MBL equals 6 x WLL
- **Finish:** polished
- **Certification:** 2.1 2.2 3.1 CE
- **Note:** marked with WLL, CE, traceability code and manufacturer identification symbol (VBS)

working load limit	diameter bow	diameter pin	diameter eye	width inside	length inside	weight per 100 pcs
t	a mm	b mm	c mm	d mm	e mm	kg
0.3	8	8	16	16	32	7.1
0.4	10	10	19	20	40	14
0.6	12	12	24	25	48	23.6
1	16	16	31	32	64	54.5
1.5	19	19	38	38	76	96
2	22	22	43	44	85	142
3	25	25	49	50	95	209

C

Thimbles, heavy type

- Material: AISI 316
- Finish: polished
- Certification: 2.1



R-7860

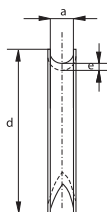
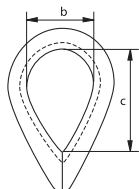

width groove	width inside	length inside	length	thickness	weight per 100 pcs
a mm	b mm	c mm	d mm	e mm	kg
2	9	15	23	1	0.2
2.5	9.5	15.7	24	1	0.2
3	10	16	25	1	0.3
4	11	17	28	1	0.5
5	13	20	32	1	0.5
6	16	25	39	1.2	0.8
7	18	28	40	1.2	1
8	20	32	49	1.4	1.2
10	26	40	55	1.9	3.4
12	28	45	70	2	4.5
14	34	56	80	2.2	7.3
16	37	62	85	2.5	12.2
18	42	65	95	2.5	15.1
20	45	78	115	3	19
22	50	88	125	3	22.3
24	58	96	135	4	40.5
26	66	105	140	4	49.7

C

Wire rope clips

Generally to DIN 741

- Material: AISI 316
- Standard: generally to DIN 741
- Finish: polished
- Certification: 2.1



R-7863

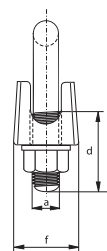
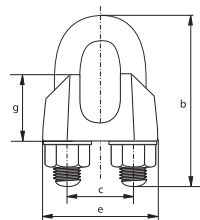

diameter wire rope	diameter	length bow	width inside	length thread	length base	thickness base	height base	weight per 100 pcs
mm	a mm	b mm	c mm	d mm	e mm	f mm	g mm	kg
3	4	20	9	12	21	10	10	1.4
4	4	22	9	12	21	10	10	1.4
5	5	24	11	13	23	11	10	1.5
6	5	28	13	15	26	12	11	2.1
8	6	34	16	19	30	14	15	3.5
10	8	42	19	22	34	18	17	6.1
13	10	55	24	30	42	23	21	13
16	12	63	29	33	50	26	26	21
19	12	75	32	38	54	29	30	26
22	14	85	37	44	61	33	34	40
26	14	95	41	45	65	35	37	44



Open body rigging screws Hook-Hook

- Material: AISI 316
- Finish: polished
- Certification: 2.1



R-7837

diameter thread	length closed position	length open position	length body	length	length	length	opening hook	thickness	weight each
a mm	b mm	c mm	d mm	e mm	f mm	g mm	h mm	h mm	kg
M 5	120	170	70	58	33	8	5	0.04	
M 6	150	210	90	73	43	9	6	0.08	
M 8	200	290	120	98	56	11	8	0.16	
M 10	240	355	150	117	71	12	9	0.27	
M 12	310	470	200	157	95	14	11	0.51	
M 16	390	590	250	186	116	16	15	1.2	
M 20	440	675	300	214	139	18	19	1.9	

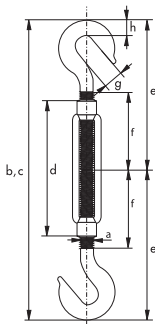

Open body rigging screws Hook-Eye

- Material: AISI 316
- Finish: polished
- Certification: 2.1



R-7838

diameter thread	length closed position	length open position	length body	length	length	length	length	opening hook	thickness	diameter eye outside	diameter eye inside	weight each
a mm	b mm	c mm	d mm	e mm	f mm	g mm	h mm	i mm	j mm	k mm	kg	
M 5	120	170	70	58	56	33	8	5	17	8	0.04	
M 6	150	210	90	73	71	43	9	6	21	10	0.08	
M 8	200	290	120	98	95	56	11	8	28	14	0.16	
M 10	240	355	150	117	118	71	12	9	34	16	0.27	
M 12	310	470	200	157	154	95	14	11	40	18	0.51	
M 16	390	590	250	186	190	116	16	15	54	26	1.2	
M 20	440	675	300	214	220	139	18	19	64	30	1.9	

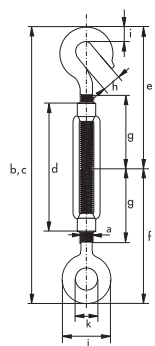

C

Open body rigging screws Eye-Eye

- Material: AISI 316
- Finish: polished
- Certification: 2.1



R-7839

diameter thread	length closed position	length open position	length body	length	length	diameter eye outside	diameter eye inside	weight each
a mm	b mm	c mm	d mm	e mm	f mm	g mm	h mm	kg
M 5	120	170	70	56	33	17	8	0.04
M 6	150	210	90	71	43	21	10	0.08
M 8	200	290	120	95	56	28	14	0.16
M 10	240	355	150	118	71	34	16	0.27
M 12	310	470	200	154	95	40	18	0.51
M 16	390	590	250	190	116	54	26	1.2
M 20	440	675	300	220	139	64	30	1.9

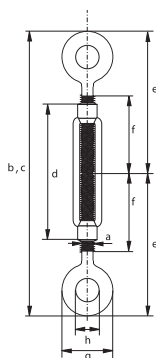

C

Closed body rigging screws Jaw-Jaw

- Material: AISI 316
- Finish: polished
- Certification: 2.1



R-7830

diameter thread	length open	length closed	length body	diameter pin	width jaw inside	weight per 100 pcs
a mm	b mm	c mm	d mm	e mm	f mm	kg
M 5	190	125	80	5.2	6	6.5
M 6	210	155	95	6.2	7.5	8.1
M 8	240	180	105	8.7	10	15.9
M 10	270	220	125	9.7	12	29.9
M 12	360	255	150	12.7	14	53.2
M 14	385	270	165	12.7	14	64
M 16	450	320	190	16	16	116
M 20	450	355	210	19	20	145

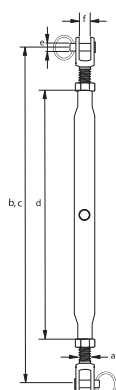

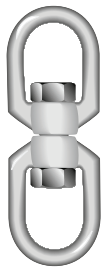

R-7877

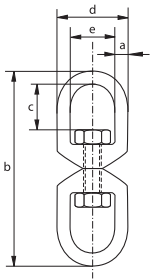

Swivels

Eye - Eye

- Material: AISI 316
- Finish: polished
- Certification: 2.1

diameter	length	length inside	width outside	width inside	weight per 100 pcs
a mm	b mm	c mm	d mm	e mm	kg
5	60	13	23	13	3.4
6	65	15	26	15	5.1
8	90	22	35	20	13.1
10	115	27	44	24	26
13	154	35	57	32	58
16	188	45	71	39	105
19	229	50	84	41	220

C

Eye bolts

Generally to DIN 580



- **Material:** AISI 316
- **Standard:** generally to DIN 580
- **Finish:** polished
- **Certification:** 2.1

R-7840

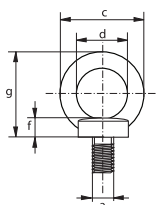

diameter thread	diameter base	diameter eye outside	diameter eye inside	length thread	thickness base	height	weight per 100 pcs
a mm	b mm	c mm	d mm	e mm	f mm	g mm	kg
M 6	20	36	20	13	6	36	3
M 8	20	36	20	13	6	36	6
M 10	25	45	25	17	8	45	10.3
M 12	30	54	30	20.5	10	53	17.7
M 16	35	63	35	27	12	62	28
M 20	40	72	40	30	14	71	45
M 24	50	90	50	36	18	90	74

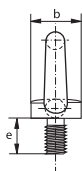

C

Eye nuts

Generally to DIN 582



- **Material:** AISI 316
- **Standard:** generally to DIN 582
- **Finish:** polished
- **Certification:** 2.1

R-7842

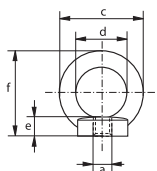

diameter thread	diameter base	diameter eye outside	diameter eye inside	thickness base	height	weight per 100 pcs
a mm	b mm	c mm	d mm	e mm	f mm	kg
M 6	20	36	20	8.5	36	4.2
M 8	20	36	20	8.5	36	5.2
M 10	25	45	25	10	45	9.4
M 12	30	54	30	11	53	14.8
M 16	35	63	35	13	62	23.7

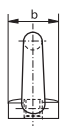

C

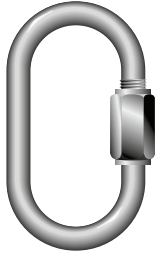

R-7873

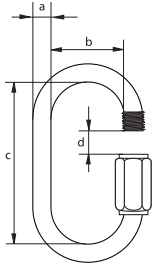

Quick links, standard type

- Material: AISI 316
- Finish: polished
- Certification: 2.1

diameter	width inside	length inside	opening	minimum breaking load	weight per 100 pcs
a mm	b mm	c mm	d mm	kg	kg
3.5	10	29	5	155	0.9
4	12	32	5.5	450	1.2
5	13	39	6.5	585	2
6	14	46	7.5	790	3.3
7	16	51	8.5	1085	5.3
8	17	59	10.5	1380	7.5
9	17	64	11.5	1790	10.3
10	20	70	12.5	2085	13.7
12	23	83	14.5	2265	22.5

C

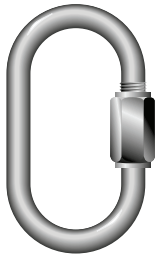

R-7874

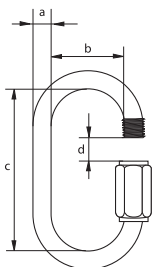

Quick links, with enlarged opening

- Material: AISI 316
- Finish: polished
- Certification: 2.1

diameter	width inside	length inside	opening	minimum breaking load	weight per 100 pcs
a mm	b mm	c mm	d mm	kg	kg
3.5	10	40	10	155	1.2
5	14	52	14	585	2.6
6	16	60	16	790	4
8	18	74	18	1380	9.1
10	20	85	20	2085	15.9
12	23	98	23	2265	30.4
14	27	116	26	2540	40.2

C

Carabine hooks, standard type

- Material: AISI 316
- Finish: polished
- Certification: 2.1

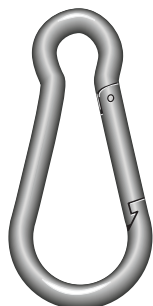

R-7872

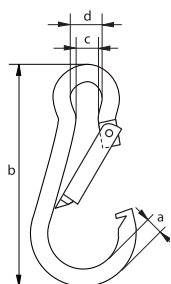

diameter	length	width inside	width inside	minimum breaking load	weight per 100 pcs
a mm	b mm	c mm	d mm	kg	kg
4	40	5	7	70	0.8
5	50	7	8	110	1.5
6	60	7	9	132	2.6
7	70	9	10	198	2.6
8	80	11	12	330	4.4
9	90	11	12	363	6.4
10	100	12	15	506	12.2
11	120	14	18	660	12.5
12	140	16	20	748	25
13	160	20	22	880	35
14	180	20	22	946	35

C

Carabine hooks, with pressed thimble

- Material: AISI 316
- Finish: polished
- Certification: 2.1

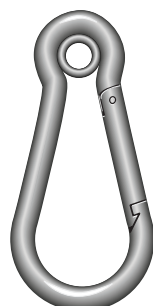

R-7875

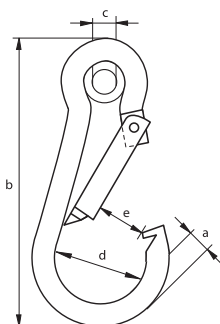

diameter	length	diameter inside thimble	width	minimum breaking load	weight per 100 pcs
a mm	b mm	c mm	d mm	kg	kg
4	40	5	14	70	0.9
5	50	5	16	110	1.6
6	60	5	18	132	2.8
7	70	7	22	198	4.4
8	80	10	24	330	6.4
9	90	10	26	363	9.3
10	100	13	30	506	12.5
11	120	13	36	660	18.7
12	140	15	40	748	25
13	160	17	44	880	35
14	180	17	48	946	50

C

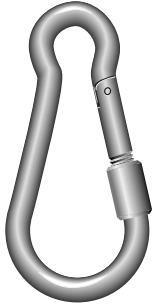

R-7876

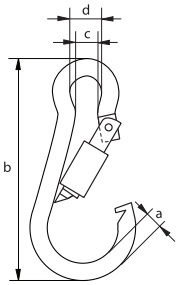

Carabine hooks, with screw nut

- Material: AISI 316
- Finish: polished
- Certification: **2.1**

diameter	length	width inside	width inside	minimum breaking load	weight per 100 pcs
a mm	b mm	c mm	d mm	kg	kg
4	40	5	7	70	0.8
5	50	7	8	110	1.7
6	60	7	9	132	2.6
7	70	9	10	198	4.4
8	80	11	12	330	6.4
9	90	11	12	363	9.3
10	100	12	15	506	12.7
11	120	14	18	660	19.5
12	140	16	20	748	25
13	160	20	22	880	35
14	180	20	22	946	50

C

Cotter Pin

Stainless steel cotter pin

- Material: AISI 304
- Finish: polished
- Certification: 2.1



R-7856

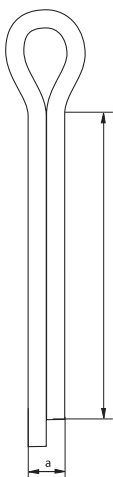

diameter	length	weight per 100 pcs
a mm	b mm	kg
2.5	20	0.08
4	32	0.3
5	36	0.6
6	45	1.2
8	63	2.8
8	80	4.4
10	71	5
10	90	6
10	100	6.6
10	120	4.4
12	140	7
12	160	7
12	180	7
13	110	12.1
16	160	16

split pin	for shackle									
	G-4163 G-4143	G-4153 G-4133	P-6036 P-6016 ≤150	G-6038 P-6018	P-6033 P-6013 ≤150	G-5263 G-5243	G-5163 G-5143	P-6031 P-6011 ≤150	G-4263 G-4243	G-4553
a x b mm	WLL t	WLL t	WLL t	WLL t	WLL t	WLL t	WLL t	WLL t	WLL t	WLL t
2.5 x 20	0.5									
	0.75									
	1									
	1.5									
4 x 32	2	2				3.3	2			
	3.25	3.25				5	3.25			
5 x 36	4.75	4.75			7	7	4.75		4.75	4.6
	6.5	6.5				9.5	6.5			
6 x 45	8.5	8.5			12.5	12.5	8.5		6.5	8.6
	9.5	9.5			18	15	9.5		8.5	
	12	12				18	12		9.5	
8 x 63	13.5	13.5				21	13.5		12	15.5
	17	17				30	17		16	
8 x 80					30					
					40					
10 x 71	25	25				40	25		25	
	35	35				55	35		30	
10 x 90	42.5	42.5				85	42.5		55	
	55	55					55			
10 x 100	85	85			55	120	85		75	
					75					
10 x 120					125					
12 x 140					150					
					200					
12 x 160					250					
12 x 180					300					
13 x 110			120	120		150		120		
			150			175		150		
16 x 160			200					200		
			250					250		
			300					300		

C

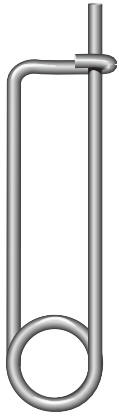

R-7850

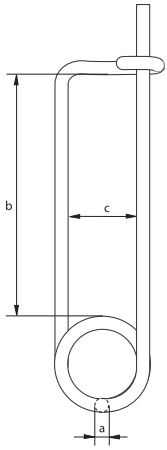

Safety Pin

Stainless steel safety pin

- Material: AISI 304 or 316
- Finish: polished
- Certification: 2.1

diameter	length inside	width inside	weight per 100 pcs
a mm	b mm	c mm	kg
2	46	18	0.5
3	66	23	1.8
3	116	24	2.5
3	147	24	2.8
4	74	29	3.9
5	95	22	6.9
6	90	39	12.5

safety pin	for shackle							
	G-4163	G-4153	P-6033	G-5263	G-5163	G-4263	G-4553	P-5367
a x b mm	WLL t	WLL t	WLL t	WLL t	WLL t	WLL t	WLL t	WLL t
2x46	4.75	4.75	7	7	4.75	4.75	4.6	
	6.5	6.5		9.5	6.5	6.5		
3x66	8.5	8.5	12.5	12.5	8.5	8.5	8.6	
	9.5	9.5	18	15	9.5	9.5		
	12	12		18	12	12		
3x116								12 - 55
3x147								85
								120
								150
4x74	13.5	13.5	30	21	13.5	16	15.5	
	17	17		30	17	25		
	25	25		40	25			
5x95	35	35	40	55	35	30		
	42.5	42.5	55		42.5			
6x90	55	55	75	85	55	55		
	85	85	125	120	85	75		

C

Single Spring Pin

Stainless steel single type spring pin

- Material: AISI 304
- Finish: polished
- Certification: 2.1

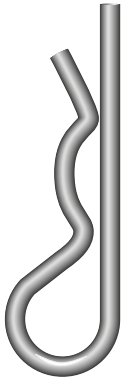

R-7852

diameter	length	diameter	diameter	weight per 100 pcs
a mm	b mm	c mm	d mm	kg
2	50	10	9 - 14	0.3
3	60	18	10 - 16	0.9
4	60	20	16 - 20	1.6
5	85	24	20 - 28	3.3
6	105	30	28 - 40	6.2
7	105	30	28 - 45	8.3
8	110	28	30 - 45	10.5

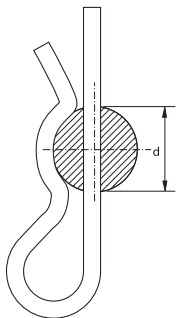
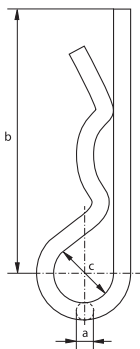

spring pin	for shackle						
	G-4163	G-4153	P-6033	G-5263	G-5163	G-4263	G-4553
diameter mm	WLL t	WLL t	WLL t	WLL t	WLL t	WLL t	WLL t
2	2	2		3.3	2		
3	3.25	3.25		5	3.25		
4	4.75	4.75	7	7	4.75	4.75	4.6
	6.5	6.5		9.5	6.5		
5	8.5	8.5	12.5	12.5	8.5	6.5	8.6
	9.5	9.5	18	15	9.5	8.5	
	12	12		18	12	9.5	
6	13.5	13.5		21	13.5	12	15.5
	17	17		30	17	16	
7	25	25	30	40	25	25	
			40				

C

Spring Pins

Stainless steel double type spring pin

- Material: AISI 304 or 316
- Finish: polished
- Certification: **2.1**

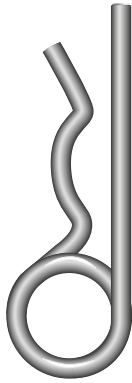

R-7854

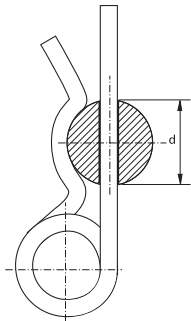
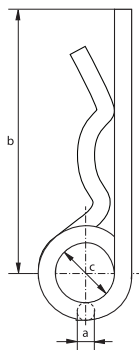

diameter	length	diameter	diameter	weight per 100 pcs
a mm	b mm	c mm	d mm	kg
2	50	10	8 - 14	0.4
3	62	16	14 - 20	1.4
3	80	15	18 - 30	2.5
4	78	23	17 - 24	3
4	110	21	24 - 45	3
4	120	21	45 - 56	3
4	150	27	45 - 56	3
5	92	26	18 - 30	5.3
6	120	30	24 - 36	9.6
7	130	30	24 - 40	13.5
8	130	30	24 - 45	17.8

spring pin	for shackle											
	G-4163	G-4153	P-6033	G-5263	G-5163	G-4263	G-4553	P-5363	P-5365	P-5367	P-5361D/F	P-5362D/F
a x b mm	WLL t	WLL t	WLL t	WLL t	WLL t	WLL t	WLL t	WLL t	WLL t	WLL t	WLL t	WLL t
2 x 50	2	2		3.3	2							
3 x 62	3.25	3.25		5	3.25				6.5~12		6.5	
3 x 80										12		
										13.5		
4 x 78	4.75	4.75	7	7	4.75	4.75	4.6	6.5	17			
	6.5	6.5		9.5	6.5		8.6		25			
	8.5	8.5		12.5	8.5				35			
4 x 110										17		
										25		
										35		
4 x 120										42.5		12~55
										55		
4 x 150										85		
										120		
										150		
5 x 92	9.5	9.5	12.5	15	9.5	6.5		9.5	42.5~85		9.5	
	12	12	18	18	12	8.5		12	120~250			
						9.5						
6 x 120	13.5	13.5		21	13.5	12	15.5	17			12	
	17	17		30	17	16					17	
											25	
8 x 130	25	25	30	40	25	25		25			35	
			40									

C

Short link chain

Generally to DIN 766 and DIN 5685-3

- **Material:** AISI 316
- **Standard:** generally to DIN 766 and DIN 5685-3
- **Certification:** [2.1](#)

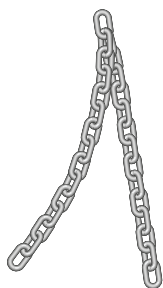

R-7880

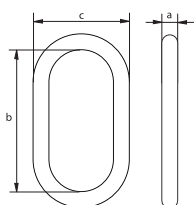

diameter	length inside	width outside	weight per meter
a mm	b mm	c mm	kg
3	16	11	0.17
4	16	14	0.32
5	18.5	17	0.5
6	18.5	20	0.75
8	24	26	1.35
10	28	34	2.25

C

Long link chain

Generally to DIN 763 and DIN 5685-1

- **Material:** AISI 316
- **Standard:** generally to DIN 763 and DIN 5685-1
- **Certification:** [2.1](#)

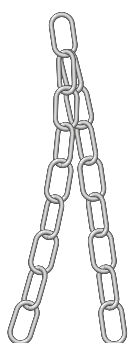

R-7890

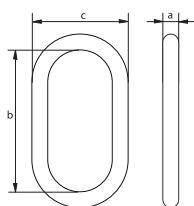

diameter	length inside	width outside	weight per meter
a mm	b mm	c mm	kg
3	26	12	0.14
4	32	16	0.27
5	36	20	0.43
6	42	24	0.63
7	48	28	0.86
8	54	32	1.1
10	66	40	1.75