



## Green Pin® rotating hoist ring range expanded

The Green Pin® Rotating Hoist Ring UNC range has been expanded with three extra sizes from WLL 6.8t up to 13.6t.

The Green Pin® Rotating Hoist Ring UNC is a grade 8 rotating hoist ring with UNC thread. This hoist ring with UNC thread can pivot 180° and rotate 360°. It has UNC threads as standard. The cylindric head of the screw prevents jamming during rotation of the shackle.

The WLL indicated hereunder are given in the worst conditions of use, i.e. 90°. It is necessary to check the free moving of the pivoting shackle. WLL and CE marking are mentioned on the product. The minimum safety factor is 5:1. The Green Pin® Rotating Hoist Ring UNC is available in a range with a working load limit from 0.4t up to 13.6t.

For more information please contact us: [sales@vanbeest.eu](mailto:sales@vanbeest.eu)

[greenpin.com](http://greenpin.com)

A VAN BEEST BRAND

## Product update

September 2021

### Green Pin® Rotating Hoist Ring UNC GR8

**Product code:** ADAUNC  
**Material:** alloy steel, Grade 8, quenched and tempered  
**Safety Factor:** MBL equals 5 x WLL  
**Finish:** painted white  
**Temperature range:** -40°C up to +200°C (-40°F up to +392°F)

**Certification:**

**2.1** **2.2** **3.1** **MTC<sup>A</sup>** **MPI<sup>b</sup>** **CE**

**Note:**

WLL indicated hereunder are given in the worst conditions of use, i.e. 90°

working load limit	torque value	diameter thread	width inside	length inside	diameter	length	thickness base	width outside	diameter base	diameter base	length inside	hex key	weight each
t	Nm	a inch	b mm	c mm	d mm	e mm	f mm	g mm	h mm	i mm	j mm	k mm	kg
0.4	6.5	5/16	35	41	13	18	35	68	34	38	43	6	0.43
0.6	13	3/8	35	39	13	18	37	68	34	38	43	8	0.44
1	22	1/2	35	36	13	24	39	68	34	38	43	10	0.46
1.7	55	5/8	35	42	13	31	43	68	34	38	52	13	0.55
2.5	110	3/4	35	38	13	31	47	68	34	38	52	16	0.55
3.5	150	7/8	53	57	20	37	69	105	49	56	71	19	1.88
4.5	190	1	53	55	20	43	71	105	49	56	71	19	1.93
6.8	380	1 1/4	53	62,5	20	55	64	105	49	56	71	19	2.11
10.8	600	1 1/2	73	92	30	75	83	146	68	77	98	19	5.65
13.6	1000	2	73	95	30	75	80	146	68	85	98	19	6.20

working load limit	torque value	diameter thread	width inside	length inside	diameter	length	thickness base	width outside	diameter base	diameter base	length inside	hex key	weight each
t	Nm	a inch	b inch	c inch	d inch	e inch	f inch	g inch	h inch	i inch	j inch	k inch	lbs
0.4	6.5	5/16	1 3/8	1 5/8	1/2	2 3/32	1 3/8	2 11/16	1 11/32	1 1/2	1 11/16	1/4	0.95
0.6	13	3/8	1 3/8	1 17/32	1/2	2 3/32	1 15/32	2 11/16	1 11/32	1 1/2	1 11/16	5/16	0.97
1	22	1/2	1 3/8	1 13/32	1/2	1 5/16	1 17/32	2 11/16	1 11/32	1 1/2	1 11/16	3/8	1.01
1.7	55	5/8	1 3/8	1 21/32	1/2	1 7/32	1 11/16	2 11/16	1 11/32	1 1/2	2 2/16	1/2	1.15
2.5	110	3/4	1 3/8	1 1/2	1/2	1 7/32	1 27/32	2 11/16	1 11/32	1 1/2	2 2/16	5/8	1.30
3.5	150	7/8	2 3/32	2 1/4	2 5/32	1 15/32	2 23/32	4 1/8	1 15/16	2 7/32	2 25/32	3/4	4.14
4.5	190	1	2 3/32	2 5/32	2 5/32	1 11/16	2 25/32	4 1/8	1 15/16	2 7/32	2 25/32	3/4	4.25
6.8	380	1 1/4	2 3/32	2 7/16	2 5/32	2 5/32	2 17/32	4 1/8	1 15/16	2 7/32	2 25/32	3/4	4.63
10.8	600	1 1/2	2 7/8	3 5/8	1 3/16	2 15/16	3 9/32	5 3/4	2 11/16	3 1/32	3 27/32	3/4	12.5
13.6	1000	2	2 7/8	3 3/4	1 3/16	2 15/16	3 5/32	5 3/4	2 11/16	3 11/32	3 27/32	3/4	13.7

Additional information on the hoist rings are available on the [FAQ PI-03-08](#)

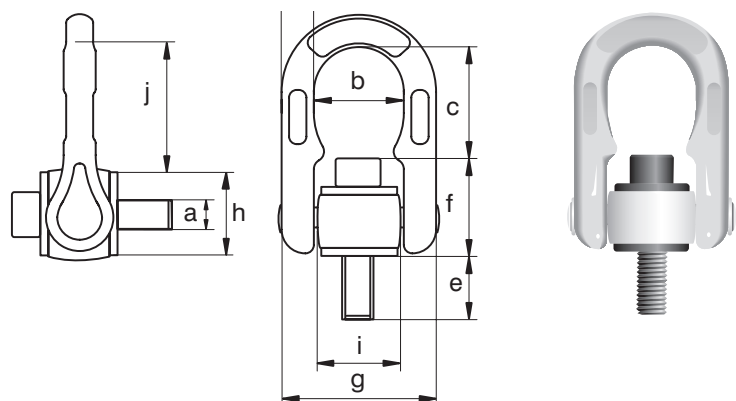



## Green Pin® Lifting Eye range expanded

The Green Pin® Lifting Eye UNC range has been expanded with three extra sizes from WLL 10t up to 25t.

The Green Pin® Lifting Eye UNC is a grade 8 lifting eye with UNC thread. Our extensive range of alloy steel lifting eyes, incorporates 13 different UNC threads. The WLL for lifting points are valid within 45° to the vertical only, but can be even side loaded with reduction of the WLL. The longer thread length of the ALUNC makes a through-hole mounting with a nut and washer on the other side possible.

The nut on the bolt should at least be class 8, but class 10 or 12 is recommended. WLL and CE marking are stamped on the body. Safety factor is 5:1. The thread length of the lifting eye should be adapted to the material of the load. The Green Pin® Lifting Eye UNC is available in a range with a working load limit from 0.2t up to 25t.

For more information please contact us: [sales@vanbeest.eu](mailto:sales@vanbeest.eu)

[greenpin.com](http://greenpin.com)

A VAN BEEST BRAND

## Product update

September 2021

### Green Pin® Lifting Eye UNC GR8

**Product code:** ALUNC  
**Material:** alloy steel, Grade 8, quenched and tempered  
**Safety Factor:** MBL equals 5 x WLL  
**Finish:** painted white  
**Temperature range:** -40°C up to +200°C (-40°F up to +392°F)

**Certification:**

**2.1** **2.2** **3.1** **MTC<sup>A</sup>** **MPI<sup>b</sup>** **CE**

working load limit	diameter thread	diameter base	diameter eye outside	diameter eye inside	length	thickness base	diameter	weight each
t	a inch	b mm	c mm	d mm	e mm	f mm	g mm	kg
0.2	1/4	20	34	20	20	17	7	0.05
0.7	3/8	20	38	22	30	19	8	0.08
1	1/2	25	47	26	36	23	10	0.14
1.5	5/8	36	65	35	53	31	14	0.38
2.5	3/4	40	73	39	58	34	16	0.55
3	7/8	42	82	44	64	38	19	0.81
4	1	55	95	54	84	40	20	1.14
5	1 1/8	55	95	54	84	40	20	1.21
6	1 1/4	60	108	59	99	47	24	1.90
8	1 1/2	65	118	67	117	45	25	2.52
10	1 3/4	70	142	80	135	61	31	4.26
15	2	70	142	80	135	61	31	4.66
25	2 1/2	95	181	97	150	69	42	9.55

working load limit	diameter thread	diameter base	diameter eye outside	diameter eye inside	length	thickness base	diameter	weight each
t	a inch	b inch	c inch	d inch	e inch	f inch	g inch	lbs
0.2	1/4	25/32	1 11/32	25/32	25/32	21/32	9/32	0.11
0.7	3/8	25/32	1 1/2	7/8	1 3/16	3/4	5/16	0.17
1	1/2	31/32	1 27/32	1 1/16	1 13/32	29/32	13/32	0.31
1.5	5/8	1 13/32	2 19/32	1 3/8	2 3/32	1 7/32	9/16	0.83
2.5	3/4	1 9/16	2 27/32	1 9/16	2 9/32	1 11/32	5/8	1.21
3	7/8	1 21/32	3 3/4	1 25/32	2 17/32	1 1/2	3/4	1.79
4	1	2 5/32	3 3/4	2 5/32	3 5/16	1 9/16	25/32	2.51
5	1 1/8	2 5/32	3 3/4	2 5/32	3 5/16	1 9/16	25/32	2.67
6	1 1/4	2 3/8	4 1/4	2 3/8	3 29/32	1 15/16	15/16	4.20
8	1 1/2	2 9/16	4 21/32	2 11/16	4 19/32	1 27/32	31/32	5.56
10	1 3/4	2 3/4	5 19/32	3 5/32	5 5/16	2 7/16	1 7/32	9.39
15	2	2 3/4	5 19/32	3 5/32	5 5/16	2 7/16	1 7/32	10.3
25	2 1/2	3 3/4	7 1/8	3 13/16	5 29/32	2 7/16	1 21/32	21.1

Additional information on the lifting eyes are available on the [FAQ PI-03-08](#)

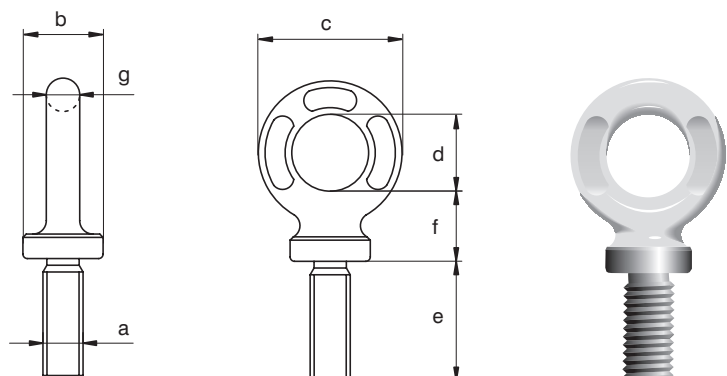

[greenpin.com](http://greenpin.com)

A VAN BEEST BRAND